

HAND TOOLS



CLAMPING. SCREWING. LOCKING.



WE GENERATE EXCITEMENT.

Since its founding by Andreas Maier in 1890, our company has lived through many exciting times. Today we are the leading manufacturer in Europe, supplying over 5,000 different products from the fields of clamping, screwing and locking. With this extensive product range we can meet all of our customers' needs and requirements. But providing optimal quality means meeting the challenges at all levels: Expert consultation, modern team organisation, individual solutions (including special developments), flexibility in response to changing conditions, etc. And we ourselves find this so exciting that we look forward every day to shaping the market together with our employees and our customers – both now and in the future. That is something you can count on.

COMPANY HISTORY

- 1890** Company founded by Andreas Maier as a lock manufacturer.
- 1920** Production program extended to include spanners.
- 1928** Production-line assembly of „FELLBACH LOCKS“.
- 1951** With the introduction of clamping elements, AMF diversified into the fields of workpiece and tool clamping.
- 1965** Toggle clamps extend the AMF product range. AMF catalogues are now published in ten languages.
- 1975** Hydraulic clamping marks further specialisation.
- 1982** Clamping and fixture systems round off AMF's clamping expertise.
- 1996** Introduction of the AMF Team Organisation in all business sectors. Quality assurance certified to ISO 9001.
- 2001** Introduction of the AMF Service Guarantee for all products.
- 2004** Introduction of the ZPS zero-point clamping system.
- 2007** The Trec clamping system for automated welding and magnetic clamping technology extend the AMF product range.
- 2009** Development and marketing of AMF Vacuum clamping technology



5 Individual development

You cannot find the product you need? Talk to us; we will find the right solution for you – from a special version, right through to a completely new development.

4 Warranty

We believe in the high quality of our products. Complaints are dealt with quickly, unbureaucratically and generously – as far as possible, even well-beyond the guarantee period.

3 Certified quality

AMF stands for painstaking production in our own works. We have followed this tradition since 1890 – today, of course, with a modern quality assurance system to ISO 9001.

2 Short delivery times

From the AMF finished-product stores with over 5,000 articles, we can supply 98 % of orders from stock. And you can be sure that every stock article ordered is dispatched the same day.

1 Real technical advice

Many tasks and a multitude of solutions. From AMF Professional Products you can find the right way to solve your problem – fast and reliably – either at your local dealer or with the help of the specialist in our team. Just call us!

E Made in Germany

It goes without saying that our range of products is developed and manufactured by our team of employees in Germany.

MANAGING DIRECTORS

- > Volker Göbel
- Johannes Maier
- Hans-Günther Maier

THE AMF SERVICE GUARANTEE

- > Assuredly on the way to the top

HEXAGON KEYS (METRIC)		9 - 21
BALL-ENDED HEXAGON KEYS (METRIC) WITH PILOT		22 - 28
HEXAGON KEYS (INCH)		29 - 32
TORX-SCREWDRIVERS		33 - 37
HOOK WRENCHES		38 - 46
COUPLING WRENCHES		47
PIN WRENCHES, WRENCH FOR 2 HOLE NUTS		48 - 50
WRENCHES FOR MACHINE TOOLS		51 - 54
SOCKET WRENCHES		55 - 58
OPEN-ENDED SPANNERS, CUSTOMER SPECIALS		59 - 62

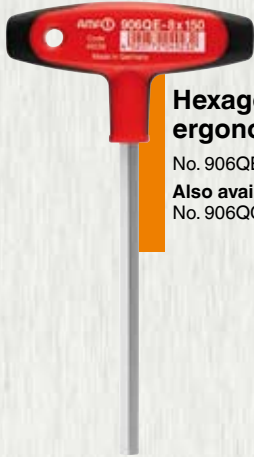

Hexagon key with ergonomic 2-component T-grip

No. 906QE, page 10
 Also available as a ball-ended hexagon key
 No. 906QGE, page 26

TORX-Schraub-boy
 No. 909ET8, page 37



Ball-ended Schraub-boy
 No. 909EG7, page 24

Workshop stand with 2-component T-grip hexagon keys
 No. 906QE-WM7, page 11



Double hexagon key with ergonomic 2-component T-grip
 No. 966QGE, page 26



TORX keys with flag-type grip
 No. 907SH, page 34

TORX key with ergonomic 2-component screwdriver grip
 No. 907LE, page 35



Hexagon key with ergonomic 2-component screwdriver grip
 No. 906E, page 11
 Also available as a ball-ended hexagon key
 No. 906GE, page 26

INDUSTRIAL VERSION



Hinged hook wrench with nose
No. 775D/775C, page 44



Hinged hook wrench with pin
No. 776D/776C, page 45

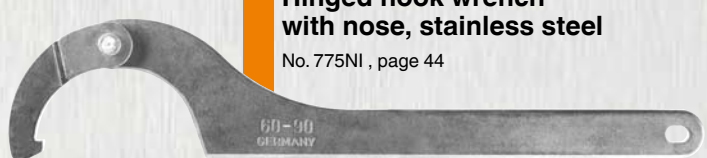

Hinged hook wrench with nose, stainless steel
No. 775NI, page 44

ASSEMBLY VERSION



Hinged hook wrench with pin
No. 776SC, page 43

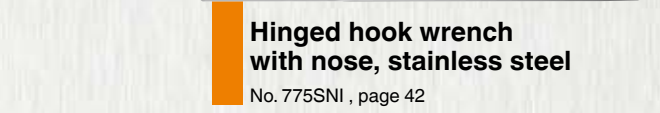

Hinged hook wrench with nose, stainless steel
No. 775SNI, page 42



Hinged hook wrench with nose
No. 775SC, page 42

YOU NEED AN ADVERTISING OR COMPANY IMPRINT? NO PROBLEM!

All conventional or T-handle screwdrivers in this catalogue can be printed with your individual advertising or company imprint in any desired colour, or in several colours, using the very economical tampon printing process.

If you need a quotation for larger quantities, please let us know how many you require and give details of your imprint (single or multicoloured).



**SPECIAL TOOLS
MADE TO YOUR SPECIFIC REQUIREMENTS!**

We will manufacture special tools in an extraordinary variety of forms and sizes to the very highest quality.

MADE-TO-MEASURE.

One of our specialities is the manufacturer of special hand tools to the individual needs of the customer.

Technical perfection is our standard!

THE CONSEQUENCES OF THIS QUALITY:

- long working life
- precise application of force, and thus
- the greatest possible safety for the user

The latest production methods in our own works. If you need it, we can make it! More starting on page 60!



1 > QUALITY FROM AMF

There are very good reasons why a discriminating user should choose the best quality screwdriving tools:

- > rigorous quality control ensures uniform standards;
- > seen as a whole, more economical, because the unproductive time spent while tools are issued is reduced to the essential minimum;
- > in sizes up to ca. 6 A/F, the torque that can be applied by hand may be higher than the test torque that is specified in the relevant standard, with the result that:
 - the wrench deforms, but only breaks under very unfavourable conditions,
 - a modest, but valuable contribution is made to safety in the workplace;
- > the true value of quality tools can only be seen in real, practical use.



2 > MATERIAL

Highly alloyed chrome-vanadium steel

- > tested steel sections in verifiably uniform quality from trusted suppliers ensure low wear for a long working-life.

3 > MANUFACTURE

- > End faces machined
- > End face up to 10 mm jaw opening chamfered process-sure
- > inspection by sampling at all stages of production

4 > EXECUTION

Hardness to DIN standards

- > the values of minimum torque specified for tightening screws up to grade 12.9 are achieved or exceeded.

5 > SURFACE FINISH

- > blued (version C)
- > nickel-plated (version D)



AN ATTRACTIVE, PRACTICAL AND HANDY ADVERTISING MEDIUM!

In your contacts with customers, there will frequently be occasions when a token of appreciation is helpful.

The SCHRAUB-boy is a sure way of achieving customer awareness. It is not only attractive, practical and handy, but also of outstanding quality. The body can be supplied in other RAL colours. All SCHRAUB-boys can be supplied, in quantities of 100 or more, printed with your company or advertising imprint (in one or more colours) applied by the tampon printing process, just as you require.

Give your business partners a SCHRAUB-boy Real quality as an advertising medium will bring you recognition and long-term success.



The SCHRAUB-boy is a super-practical mini-workshop in pocket-knife format. There are three different versions (ballended or TORX version – see Cat. pages 24 and 37). A really useful addition to professional and d-i-y toolkits. A single tool that fits in the palm of your hand and can perform up to 14 functions. Socket, TORX, or Philips screws are no problem, and, when refreshment is called for, there is even a bottle opener.

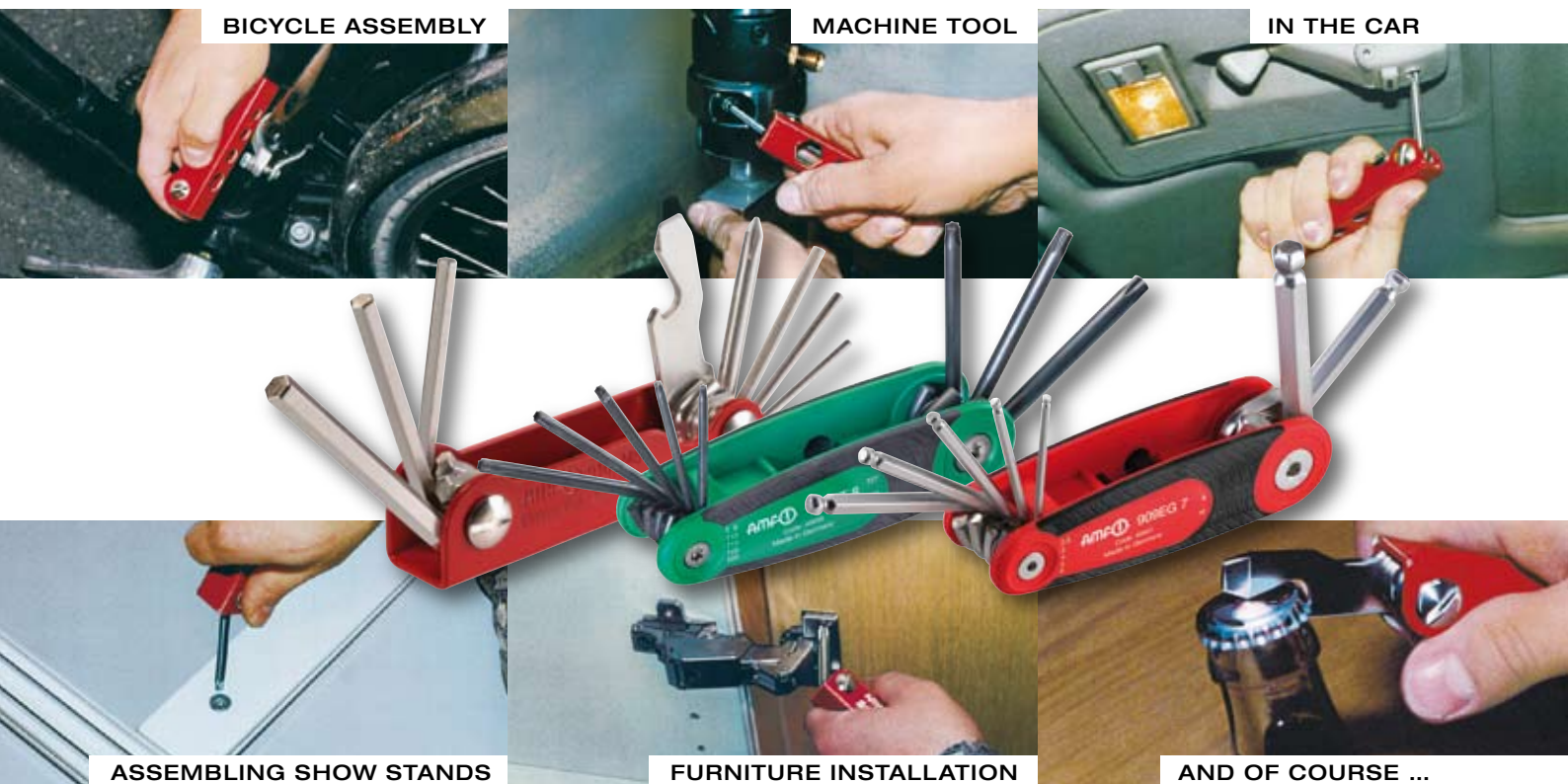

No. 910

SCHRAUB-boy (metric)

Blades: CHROM VANADIUM, hardened and **nickel-plated**.
Body: plastic-coated steel.



Order no.	Size	L x W x H	Weight [g]
44875	M6	95 x 28 x 25	180
44800	M8	95 x 28 x 25	180

Application:

The SCHRAUB-boy is a super-practical mini-workshop in pocket-knife format. There are four different versions (for TORX and ball-ended version, see No. 909ET8 and 909EG7). A really useful addition to professional and d-i-y toolkits. A single tool that fits in the palm of your hand and can perform up to 14 functions. Hexagon, TORX or Philips screw are no problem. And when refreshment is called for, there is even a bottle opener.

Dimensions

Order no.	ISO 2936	DIN ISO 8764	sim. DIN5264	DIN 659
44875	2, 2.5, 3, 4, 5 mm	1 + 2	0.5x3.5, 1x7 mm	7, 8, 10, 13 mm
44800	1.5, 2, 2.5, 3, 4, 5, 6 mm	1	1x7 mm	7, 8, 10, 13 mm

No. 906M

Biketool

16-piece multi-purpose tool in pocket format.
A professional tool specially for the cyclist, for rapid repair after any breakdown.
Tools: hardened and **blued**.
Case: two-component body.



Order no.	L x W x H	Weight [g]
45666	90 x 50 x 32	260

Design:

7 Hexagon keys: 2 - 2.5 - 3 - 4 - 5 - 6 and 8 mm A/F
2 Screwdrivers: + PH2 / -1 x 5
3 Socket spanners: 8 - 9 - 10 mm
3 Open-ended spanners: 8 -10 -15 mm
1 Spoke key: 14 G.



THE ADVANTAGES OF THE 2-COMPONENT HANDLES:

- > new, ergonomic 2-component handle
- > grip shape optimised for comfortable use
- > easy tightening when applying full torque
- > high-quality, impact-resistant, cadmium-free plastic.

No. 906QE

Hexagon key (metric) with ergonomic 2-component T-grip

Blade: CHROME VANADIUM, hardened and nickel-plated.
Grip: impact-resistant plastic (cadmium-free), black/red.

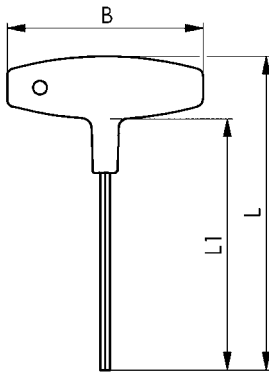

Order no.	A/F [mm]	A/F [inch]	L1	B	L	Weight [g]
49007	2,0	5/64	100	80	125	18
49015	2,5	-	100	80	125	24
49023	2,5	-	150	80	175	27
49031	2,5	-	200	80	225	30
49049	3	-	100	80	125	24
49056	3	-	150	80	175	30
49064	3	-	200	80	225	40
49072	3	-	350**	100	381	117
49080	4	5/32	100	80	125	31
49098	4	5/32	150	80	175	36
49106	4	5/32	200	80	225	41
49114	4	5/32	300	80	325	50
49122	4	5/32	350**	100	381	117
49130	5	-	100	100	131	51
49148	5	-	150	100	181	60
49155	5	-	200	100	231	68
49163	5	-	350	100	381	100
49171	5	-	450**	100	488	240
49189	6	-	100	100	131	58
49197	6	-	150	100	181	77
49205	6	-	200	100	231	84
49213	6	-	350	100	381	130
49221	8	5/16	100	100	131	85
49239	8	5/16	150	100	181	105
49247	8	5/16	200	100	231	125
49254	8	5/16	350	100	381	200
49262	10	-	100	100	138	165
49270	10	-	200	100	238	223
49288	10	-	350	100	388	350

** With reinforced blade

Advantage:

Hexagon keys with new ergonomic 2-component T-grip

set apart by:

- optimised grip design for convenient handling
- sensitive tightening when applying full torque
- hang-up hole for a tidy workplace.

Note:

Please see also workshop stands no. 906QE-WM7.

On request:

Advertising or company imprint?

These conventional or T-grip keys are particularly suitable for printing with your individual advertising or company logo using the tampon printing process. If you need larger quantities, ask for our quotation. Please state the quantity required and printing details (one or more colours).

No. 906E

Hexagon key (metric) with ergonomic 2-component screwdriver grip

Blade: CHROME VANADIUM, hardened and **nickel-plated**.
Grip: impact-resistant plastic (cadmium-free), black/red.

Order no.	A/F [mm]	L1	L	Weight [g]
40931	2,0	60	150	34
40949	2,5	75	165	36
40956	3,0	75	165	38

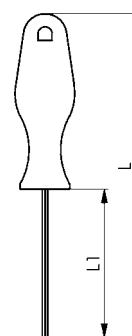

No. 906QE-WM7

Workshop stand (metric)

with 2-component T-grip hexagon keys no. 906QE, metric, 7-piece set.
Blades: CHROME VANADIUM, hardened and **nickel-plated**.
Grip: impact-resistant plastic (cadmium-free), black/red.
Stand: single-grade, impact-resistant **plastic** with clips for connecting further workshop stands.

Order no.	Contents: A/F x blade length L1	Weight [g]
49577	2x100, 2,5x100, 3x150, 4x150, 5x150, 6x200, 8x200	650



Specifications subject to change.

No. 906Q

Hexagon keys (metric) with T-grip

Key: CHROM VANADIUM, hardened and **nickel-plated**.
Grip: impact-resistant plastic (cadmium-free), red.

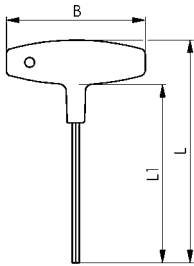

Order no.	A/F [mm]	A/F [inch]	L1	B	L	Weight [g]
42242	2	5/64	100	80	125	18
42259	2,5	-	100	80	125	24
44958	3	-	100	80	125	24
44966	3	-	150	80	175	30
44974	3	-	200	80	225	40
44982	4	5/32	100	80	125	31
44990	4	5/32	150	80	175	36
45005	4	5/32	200	80	225	41
45013	5	-	100	100	131	51
42218	5	-	150	100	181	60
45021	5	-	200	100	231	68
45039	6	-	100	100	131	58
45047	6	-	150	100	181	77
45054	6	-	200	100	231	84
45062	8	5/16	100	100	131	85
45070	8	5/16	150	100	181	105
42234	8	5/16	200	100	231	125
45096	10	-	200	120	238	223
45112	12	-	200	120	238	307

Advantage:

Hexagon keys with ergonomic T-grip with:
- shape of grip optimised for comfortable use
- permits sensitive tightening with full torque
- hole for hanging up, for a tidy workplace.

Note:

Please see also workshop stands no. 906-WM**.

No. 906

Hexagon keys (metric) with screwdriver handle

Blade: CHROME VANADIUM, hardened and **nickel-plated**.
Grip: impact-resistant plastic (cadmium-free), red.

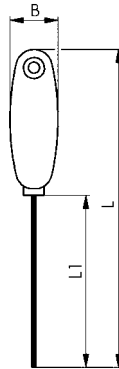

Order no.	A/F [mm]	L1	B	L	Weight [g]
42200	1,5	90	25	166	18
42168	2,0	90	25	166	21
42184	2,5	90	25	166	24
42192	3,0	90	25	166	26

No. 906S

Hexagon keys (metric) with small grip

Blade: CHROME-VANADIUM, hardened, **steel-grey**.
Grip: impact-resistant plastic, red.

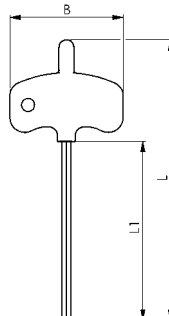

Order no.	A/F [mm]	L1	B	L	Weight [g]
47548	1,5	60	38	95	9
47555	2,0	60	38	95	7
47563	2,5	60	38	95	11
47571	3,0	60	38	95	12

Application:

...fast for low tightening torques e.g. for cutting tool tips!

No. 906-WM7M

Workshop stand (metric), metal

with no. 906 screwdriver-handle keys, and no. 906Q T-grip keys (metric), 7-piece set.
 Blades: CHROME-VANADIUM, hardened and **nickel-plated**.
 Grips: impact-resistant plastic (cadmium-free), red.
 Stand: plastic-coated **metal**.

Order no.	Contents: A/F x blade length L1	Weight [g]
42283	906-2x90, 2,5x90, 3x90; 906Q-4x150, 5x150, 6x200, 8x200	1030



No. 906Q-WM7

Workshop stand (metric)

with T-grip hexagon keys no.906Q, metric, 7-piece set.
 Blades: CHROME VANADIUM, hardened and **nickel-plated**.
 Grip: impact-resistant plastic (cadmium-free), red.
 Stand: single-grade, impact-resistant **plastic** with clips for connecting further workshop stands.

Order no.	Contents: A/F x blade length L1	Weight [g]
42606	2x100, 2,5x100, 3x150, 4x150, 5x150, 6x150, 8x150	575



No. 906-WM9

Workshop stand (metric)

with no. 906 screwdriver-handle keys and no. 906Q T-grip keys (metric), 9-piece set.
 Blades: CHROME-VANADIUM, hardened and **nickel-plated**.
 Grips: impact-resistant plastic (cadmium-free), red.
 Stand: single-grade, impact-resistant **plastic** with clips for connecting further workshop stands.

Order no.	Contents: A/F x blade length L1	Weight [g]
42291	906-1,5x, 2x, 2,5x, 3x90; 906Q-4x, 5x150, 6x, 8x, 10x200	860



APPLICATION OF OUR HEXAGON KEYS TO ISO 2936 DIN 6911 AND BALLEDED KEYS.

The table shows the across-flats sizes of keys for thread sizes (M) and types of screw.

A/F mm	Test torque		Hard- ness HRC	Socket screw standards				
	hexagon Nm	ball-ended Nm		ISO 4762 [DIN 912]	DIN 6912	DIN 7984	ISO 10642 [DIN 7991]	ISO 4026-4029 [DIN 913-916]
0,7	0,08	-	52-55	-	-	-	-	M1,4 M1,6 (M1,8)
0,9	0,18	-		-	-	-	-	M2
1,3	0,53	-		(M1,4)	-	-	-	M2,5
1,5	0,82	0,40		M1,6 M2	-	-	-	M3
2,0	1,90	0,98		M2,5	-	M3	M3	M4
2,5	3,80	1,60		M3	-	M4	M4	M5
3	6,60	2,90		M4	M4	M5	M5	M6
4	16	6,40		M5	M5	M6	M6	M8
5	30	12		M6	M6	M8	M8	M10
6	52	21		M8	M8	-	M10	M12 (M14)
7	80	-	-	-	M10	M12	-	
8	120	50	M10	M10	-	-	M16	
10	220	92	48-52	M12	M12	M14	M14 M16	(M18) M20
12	370	250		M14	M14	M16 M18	(M18) M20	(M22) M24
14	590	-		M16 M18	M16 M18	M20 M22	(M22) M24	-
17	980	-	45 - 50	M20	M20 M22	M24	-	-
19	1360	-		(M22)	M24 M27	-	-	-
22	2110	-		M24 (M27)	M30	-	-	-
24	2750	-		M30	M33	-	-	-
				M33	-	-	-	-
27	3910	-		M36	M36	-	-	-
32	4000	-		M42	-	-	-	-
36	4000	-		M48	-	-	-	-

() not ISO standard thread

ISO 2936C

Hexagon keys (metric)

CHROM VANADIUM, hardened and blued.
End face machined. Edges of end face chamfered.



Order no.	A/F [mm]	L1 x L2 [mm]	Weight [g]
42572	0,7	33 x 7	0,14
42580	0,9	33 x 11	0,2
43067	1,3	41 x 13	0,7
42358	1,5	46,5 x 15,5	0,9
42366	2,0	52,0 x 18,0	1,8
42374	2,5	58,5 x 20,5	3,0
42382	3	66 x 23	5,0
42390	4	74 x 29	10
42408	5	85 x 33	18
42416	6	96 x 38	30
42424	7	102 x 41	43
42432	8	108 x 44	59
42440	9	114 x 47	79
42457	10	122 x 50	103
42465	11	129 x 53	131
42473	12	137 x 57	160
42481	14	154 x 70	260
42499	17	177 x 80	430
42507	19	199 x 89	617
42515	22	222 x 102	920
42523	24	248 x 114	1238
42531	27	277 x 127	1740
42549	30	315 x 142	2410
42556	32	347 x 157	3080
42564	36	391 x 176	4370

The 1.3 A/F key is in fact 1.27 mm, which is precisely 0.05".

ISO 2936LC

Hexagon keys (metric), long version

CHROM VANADIUM, hardened and blued.
End face machined. Edges of end face chamfered.

Order no.	A/F [mm]	L1 x L2 [mm]	Weight [g]
43703	1,5	91,5 x 15,5	1,5
43711	2,0	102,0 x 18,0	3,0
43729	2,5	114,5 x 20,5	5,5
43737	3	129 x 23	9,0
43745	4	144 x 29	18
43752	5	165 x 33	32
43760	6	186 x 38	52
43778	7	197 x 41	74
43786	8	208 x 44	100
43794	10	234 x 50	177
43802	12	262 x 57	287
43810	14	294 x 70	440

On request:

Other lengths and executions on request.

Specifications subject to change.

ISO 2936D

Hexagon keys (metric)

CHROM VANADIUM, hardened and **nickel-plated**
End face machined. Edges of end face chamfered.



Order no.	A/F [mm]	L1 x L2 [mm]	Weight [g]
43299	1,3	41 x 13	0,7
42630	1,5	46,5 x 15,5	0,9
42648	2,0	52,0 x 18,0	1,8
42655	2,5	58,5 x 20,5	3,0
42663	3	66 x 23	5,0
42671	4	74 x 29	10
42689	5	85 x 33	18
42697	6	96 x 38	30
42705	7	102 x 41	43
42713	8	108 x 44	59
42721	9	114 x 47	79
42739	10	122 x 50	103
42747	11	129 x 53	131
42754	12	137 x 57	160
42762	14	154 x 70	260
42770	17	177 x 80	430
42788	19	199 x 89	617
42796	22	222 x 102	920

The 1.3 A/F key is in fact 1.27 mm, which is precisely 0.05".

On request:

Other lengths and executions on request.

ISO 2936LD

Hexagon keys (metric), long version

CHROM VANADIUM, hardened and **nickel-plated**.
End face machined. Edges of end face chamfered.



Order no.	A/F [mm]	L1 x L2 [mm]	Weight [g]
42614	1,5	91,5 x 15,5	1,5
42895	2,0	102,0 x 18,0	3,0
42903	2,5	114,5 x 20,5	5,5
42911	3	129 x 23	9,0
42937	4	144 x 29	18
42945	5	165 x 33	32
42952	6	186 x 38	52
43596	7	197 x 41	74
42960	8	208 x 44	100
42978	10	234 x 50	177
42986	12	262 x 57	287
42994	14	294 x 70	440
43000	17	337 x 80	750
43018	19	379 x 89	1100

On request:

Other lengths and executions on request.

No. 911-WM9M

Workshop stand (metric), metal

with metric hexagon keys ISO 2936, 9-piece set.
 Key: CHROM VANADIUM, hardened and **nickel-plated**.
 End face machined. Edges of end face chamfered.
 Stand: plastic-coated **metal**.

Order no.	Contents: A/F	Weight [g]
44032	2.5, 3, 4, 5, 6, 8, 10, 12, 14 mm	1240



No. 911L-WM9M

Workshop stand (metric), metal

with metric hexagon keys ISO 2936L, **long version**, 9-piece set.
 Key: CHROM VANADIUM, hardened and **nickel-plated**. End face machined. Edges of end face chamfered. Stand: plastic-coated metal.

Order no.	Contents: A/F	Weight [g]
44040	2.5, 3, 4, 5, 6, 8, 10, 12, 14 mm	1700



No. 911-WM9

Workshop stand (metric)

with metric hexagon keys ISO 2936, 9-piece set.
 Key: CHROM VANADIUM, hardened and **nickel-plated**.
 End face machined. Edges of end face chamfered.
 Stand: single-grade, impact-resistant **plastic** with clips
 for connecting further workshop stands.

Order no.	Contents: A/F	Weight [g]
44065	2.5, 3, 4, 5, 6, 8, 10, 12, 14 mm	840



No. 911L-WM9

Workshop stand (metric)

with metric hexagon keys ISO 2936L, **long version**, 9-piece set.
 Key: CHROM VANADIUM, hardened and **nickel-plated**.
 End face machined. Edges of end face chamfered.
 Stand: single-grade, impact-resistant **plastic** with clips
 for connecting further workshop stands.

Order no.	Contents: A/F	Weight [g]
44099	2.5, 3, 4, 5, 6, 8, 10, 12, 14 mm	1310



No. 911BM7D

Key box (metric)

with metric hexagon keys ISO 2936, 7-piece set.
 Keys: CHROME VANADIUM, hardened and **nickel-plated**.
 End face machined. Edges of end face chamfered.
 Box: impact-resistant **plastic** with self-service rack slot.

Order no.	Contents: A/F	L x W x H	Weight [g]
44826	2, 2.5, 3, 4, 5, 6, 8 mm	133 x 72 x 14	175



No. 911BM10D

Key box (metric)

with metric hexagon keys ISO 2936, 8-piece set.
 Keys: CHROME VANADIUM, hardened and **nickel-plated**.
 End face machined. Edges of end face chamfered.
 Box: from impact-resistant **plastic** with self-service rack slot.

Order no.	Contents: A/F	L x W x H	Weight [g]
46037	2, 2.5, 3, 4, 5, 6, 8, 10 mm	177 x 88 x 17	320



No. 911L-BM8D

Key box (metric)

with metric hexagon keys ISO 2936L, long version, 8-piece set.
 Keys: CHROME VANADIUM, hardened and **nickel-plated**.
 End face machined. Edges of end face chamfered.
 Box: impact-resistant **plastic** with self-service rack slot.

Order no.	Contents: A/F	L x W x H	Weight [g]
46003	2, 2.5, 3, 4, 5, 6, 8, 10 mm	265 x 88 x 17	535



No. 911TM

Key wallet (metric)

with metric hexagon keys ISO 2936, 6, 8 and 10-piece set.
 Keys: CHROME VANADIUM, hardened and **nickel-plated**.
 End faces machined. Edges of end face chamfered.
 Plastic wallet with slot for self-service rack and reusable closure.

Order no.	Size	Contents: A/F	Weight [g]
43851	6	2, 2.5, 3, 4, 5, 6 mm	75
43869	8	2, 2.5, 3, 4, 5, 6, 8, 10 mm	235
43877	10	2, 2.5, 3, 4, 5, 6, 8, 10, 12, 14 mm	660



No. 911L-TM7

Key wallet (metric)

with metric hexagon keys ISO 2936L, **long version**, 7-piece set.
 Key: CHROME VANADIUM, hardened and **nickel-plated**.
 End faces machined. Edges of end face chamfered.
 Plastic wallet with slot for self-service rack and reusable closure.

Order no.	Contents: A/F	Weight [g]
43927	2, 2.5, 3, 4, 5, 6, 8 mm	230



No. 911-HM9C

Key holder (metric)

with metric hexagon keys ISO 2936, 9-piece set.
 Keys: CHROME-VANADIUM, hardened and **blued**.
 End face machined. Edges of end face chamfered.
 Holder: with slot for self-service rack.

Order no.	Contents: A/F	Weight [g]
89425	1.5, 2, 2.5, 3, 4, 5, 6, 8, 10 mm	245



No. 911L-HM9C

Key holder (metric)

with metric hexagon keys ISO 2936L, **long version**, 9-piece set.
 Keys: CHROME-VANADIUM, hardened and **blued**.
 End face machined. Edges of end face chamfered.
 Holder: with slot for self-service rack.

Order no.	Contents: A/F	Weight [g]
89433	1.5, 2, 2.5, 3, 4, 5, 6, 8, 10 mm	415



No. 911-HMD

Key holder (metric)

with metric hexagon keys ISO 2936, 7 and 9-piece set.
 Keys: CHROME VANADIUM, hardened and **nickel-plated**.
 End face machined. Edges of end face chamfered.
 Holder: with slot for self-service rack.

Order no.	Size	Contents: A/F	Weight [g]
46136	7	1.5, 2, 2.5, 3, 4, 5, 6 mm	80
46789	9	1.5, 2, 2.5, 3, 4, 5, 6, 8, 10 mm	245



No. 911L-HM9D

Key holder (metric)

with metric hexagon keys ISO 2936L, **long version**, 9-piece set.
 Keys: CHROME VANADIUM, hardened and **nickel-plated**.
 End face machined. Edges of end face chamfered.
 Holder: with slot for self-service rack

Order no.	Contents: A/F	Weight [g]
46797	1.5, 2, 2.5, 3, 4, 5, 6, 8, 10 mm	415



DIN 6911D

Hexagon key (metric) with pilot

for DIN 6912 screws. CHROM VANADIUM, hardened and **nickel-plated**.



Order no.	A/F [mm]	L1 x L2 [mm]	Weight [g]
45377	3	66 x 23	5
45385	4	74 x 29	10
45393	5	85 x 33	18
45401	6	96 x 38	30
45419	8	108 x 44	59
45427	10	122 x 50	103
45435	12	137 x 57	160
45443	14	154 x 70	260
45450	17	177 x 80	430

No. 6911 BM7

Key box (metric)

with metric hexagon keys DIN 6911 with pilot for DIN 6912 screws, 7-piece set.

Key: CHROM VANADIUM, hardened and **nickel-plated**.

Box: impact-resistant plastic.

Order no.	Contents: A/F	L x W x H	Weight [g]
44867	ISO 2936-2, 2.5; DIN 6911-3, 4, 5, 6, 8 mm	133 x 72 x 14	175





APPLICATIONS

- At angles up to 25°
- > speeds up work in hard-to-reach locations,
 - > easy but still precise entry of key into socket.

MATERIAL

- Highly alloyed chrome-vanadium steel
- > ensures a long working-life, good torque-resistance, and optimum hardness
 - > see table on page 14 for test torques.

EXECUTION AND SURFACE FINISH

- hardened, steel-grey (version C)
hardened and nickel-plated (version D)

No. 911G-C

Ball-ended hexagon key (metric)

CHROM VANADIUM, hardened, steel-grey.



Order no.	A/F [mm]	L1 x L2 [mm]	Weight [g]
46458	1,5	46,5 x 15,5	1
46474	2,0	52,0 x 18,0	2
46490	2,5	58,5 x 20,5	3
46516	3	66 x 23	5
46532	4	74 x 29	11
46557	5	85 x 33	20
46573	6	96 x 38	32
46599	8	108 x 44	65
46466	10	122 x 50	113

Packing unit = 10 pieces per size and order no.

No. 911G-BM10

Key box

with ball-ended hexagon key (metric) no. 911G, short version, 8-piece set.
 Keys: CHROME VANADIUM, hardened and **steel-grey**.
 Box: impact-resistant plastic with self-service rack slot.

Order no.	Contents: A/F	L x W x H	Weight [g]
46052	2, 2.5, 3, 4, 5, 6, 8, 10 mm	170 x 88 x 17	320



No. 911G-TM7

Key wallet

with ball-ended hexagon key (metric) no. 911G, short version, 7-piece set.
 Key: CHROM VANADIUM, hardened, **steel-grey**.
 Plastic wallet with slot for self-service rack and reusable closure.

Order no.	Contents: A/F	Weight [g]
46102	1.5, 2, 2.5, 3, 4, 5, 6 mm	75



Nr. 909EG7

Ball-ended SCHRAUB-boy

Grip: from ergonomic 2-component housing.
Lift mechanism offers convenient access to the blades.
 Blades: hardened and nickel-plated.

Order no.	Contents: A/F	Weight [g]
45641	2.5, 3, 4, 5, 6, 8, 10	280



No. 911LG-C

Ball-ended hexagon key (metric), long version

CHROM VANADIUM, hardened, **steel-grey**.



Order no.	A/F [mm]	L1 x L2 [mm]	Weight [g]
46086	1,5	91,5 x 15,5	2
45898	2,0	102,0 x 18,0	3
45823	2,5	114,5 x 20,5	6
45831	3	129 x 23	9
45849	4	144 x 29	19
45856	5	165 x 33	34
45864	6	186 x 38	54
45872	8	208 x 44	110
45880	10	234 x 50	190
46060	12	262 x 57	295

No. 911LG-D

Ball-ended hexagon key (metric), long version

CHROM VANADIUM, hardened and **nickel-plated**.



Order no.	A/F [mm]	L1 x L2 [mm]	Weight [g]
47209	1,5	91,5 x 15,5	2
47217	2,0	102,0 x 18,0	3
47225	2,5	114,5 x 20,5	6
47233	3	129 x 23	9
47241	4	144 x 29	19
47258	5	165 x 33	34
47266	6	186 x 38	54
47274	8	208 x 44	110
47282	10	234 x 50	190
47290	12	262 x 57	295

No. 911LG-WM9

Workshop stand (metric)

with ball-ended hexagon keys (metric), no. 911LG, long version, 9-piece set.

Keys: CHROME VANADIUM, hardened and **nickel-plated**.

Stand: single-grade, impact-resistant **plastic** with clips for connecting further workshop stands

Order no.	Contents: A/F	Weight [g]
42341	1.5, 2, 2.5, 3, 4, 5, 6, 8, 10 mm	615

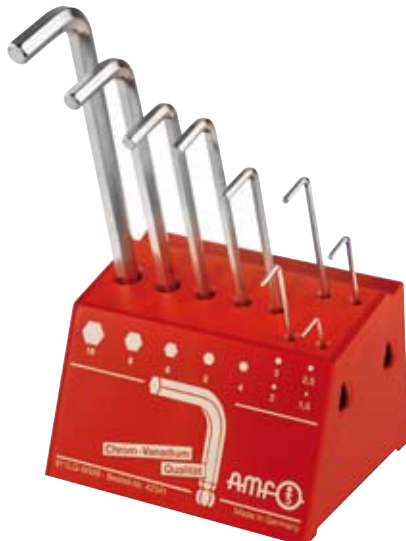

Nr. 906QGE

Ball-ended hexagon key (metric) with ergonomic 2-component T-grip

Blade: CHROME VANADIUM, hardened and nickel-plated.
Grip: impact-resistant plastic (cadmium-free), black/red.



Order no.	A/F [mm]	L1	B	L	Weight [g]
47118	4	150	80	175	40
47126	5	150	100	181	65
47134	6	150	100	181	80
47142	8	200	100	231	130

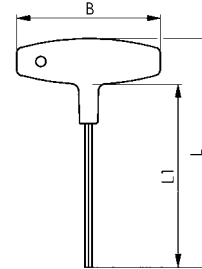

No. 906GE

Ball-ended hexagon key (metric) with ergonomic 2-component screwdriver grip

Blade: CHROME VANADIUM, hardened and nickel-plated.
Grip: impact-resistant plastic (cadmium-free), black/red.



Order no.	A/F [mm]	L1	L	Weight [g]
45757	2,5	100	190	35
45765	3,0	100	190	35
45773	4,0	100	200	50
45781	5,0	100	200	75

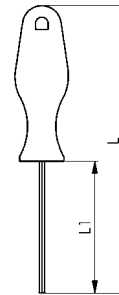

Nr. 966QGE

Double hexagon key (metric) with ergonomic 2-component T-grip

Blade: CHROME VANADIUM, hardened and nickel-plated.
Grip: impact-resistant plastic (cadmium-free), black/red
with lateral take-off.
Short arm for final tightening. Long arm for speed.

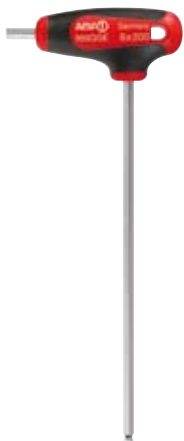

Order no.	A/F [mm]	L1	B	L	L2	Weight [g]
47670	3	100	73	130	13	25
47613	4	150	85	185	15	50
47621	5	150	85	185	15	60
47639	6	200	97	240	17	100

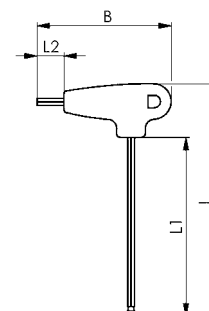

No. 911LG-HMC

Key holder

with ball-ended hexagon keys (metric) no. 911LG, **long version**, 7- or 9-piece set.
 Keys: CHROME VANADIUM, hardened, **steel-grey**.
 Holder: with slot for self-service rack.



Order no.	Size	Contents: A/F	Weight [g]
89409	7	1.5, 2, 2.5, 3, 4, 5, 6 mm	140
46524	9	1.5, 2, 2.5, 3, 4, 5, 6, 8, 10 mm	440

No. 911LG-HM9D

Key holder

with ball-ended hexagon keys (metric), no. 911LG, **long version**, 9-piece set.
 Keys: CHROME VANADIUM, hardened and **nickel-plated**.
 Holder: with slot for self-service rack



Order no.	Contents: A/F	Weight [g]
46805	1.5, 2, 2.5, 3, 4, 5, 6, 8, 10 mm	440

No. 911LG-HM7D

Key holder (Combiclip)

With ball-ended hexagon keys (metric) no. 911LG, long version, 7-piece set.
 Key: CHROM VANADIUM, hardened and **nickel-plated**.



Order no.	Contents: A/F	Weight [g]
46813	1.5, 2, 2.5, 3, 4, 5, 6 mm	150

Application:

The key holder is a convenient, tidy way of storing 7 sizes of key, and can also be used as at T-grip by repositioning the key needed in the holder.



No. 911LG-BM8C

Key box

with ball-ended hexagon keys (metric) no. 911LG, **long version**.
 Keys: CHROM VANADIUM, hardened, **steel-grey**.
 Box: impact-resistant plastic with self-service rack slot.

Order no.	Contents: A/F	L x W x H	Weight [g]
46011	2, 2.5, 3, 4, 5, 6, 8, 10 mm	265 x 88 x 17	530



No. 911LG-BM8D

Key box

with ball-ended hexagon key (metric) no. 911LG, **long version**, 8-piece set.
 Keys: CHROME-VANADIUM, hardened and **nickel-plated**.
 Box: from impact-resistant plastic with self-service rack slot.

Order no.	Contents: A/F	L x W x H	Weight [g]
46078	2, 2.5, 3, 4, 5, 6, 8, 10 mm	265 x 88 x 17	530



Nr. 911LG-TM9

Key wallet

with ball-ended hexagon keys (metric), no. 911LG, **long version**, 9-piece set.
 Keys: CHROME VANADIUM, hardened and **nickel-plated**.
 Plastic wallet with slot for self-service rack and reusable closure.

Order no.	Contents: A/F	Weight [g]
43885	1.5, 2, 2.5, 3, 4, 5, 6, 8, 10	400



No. 2936DZ

Hexagon keys (inch)

CHROM VANADIUM, hardened and **nickel-plated**.
End face machined, edges of end face chamfered.



Order no.	A/F [inch]	A/F [mm]	L1 x L2 [mm]	Weight [g]
43281	0,05*	1,27	41 x 13	0,7
43307	1/16	1,59	47 x 16	1,0
43315	5/64*	2,00	52 x 18	1,8
43323	3/32	2,38	58 x 20	2
43331	1/8	3,18	66 x 23	5
43497	9/64	3,57	72 x 26	7
43349	5/32*	4,00	74 x 29	10
43356	3/16	4,76	85 x 33	15
43364	7/32	5,56	91 x 36	23
43372	1/4	6,35	96 x 38	31
43380	9/32*	7,00	102 x 41	43
43398	5/16*	8,00	108 x 44	59
43406	3/8	9,53	122 x 50	92
43414	7/16*	11,00	129 x 53	131
43422	1/2	12,70	145 x 63	206
43430	9/16	14,29	154 x 69	280
43448	5/8	15,88	176 x 76	350
43455	3/4*	19,00	199 x 89	617
43463	7/8*	22,00	222 x 102	920
43471	1	25,40	275 x 125	1390

Keys marked * correspond to the metric size.
Above 5/32" A/F they are marked with both sizes.

No. 2936LDZ

Hexagon keys (inch), long version

CHROM VANADIUM, hardened and **nickel-plated**.
End face machined, edges of end face chamfered.



Order no.	A/F [inch]	A/F [mm]	L1 x L2 [mm]	Weight [g]
43273	1/16	1,59	92 x 16	1,5
43505	5/64*	2,00	102 x 18	3,0
43539	3/32	2,38	114 x 20	3,5
43547	1/8	3,18	129 x 23	7,4
43604	9/64	3,57	140 x 26	12
43513	5/32*	4,00	144 x 29	18
43562	3/16	4,76	165 x 33	26
43570	7/32	5,56	176 x 36	40
43588	1/4	6,35	186 x 38	54
43521	9/32*	7,00	207 x 42	74
43554	5/16*	8,00	208 x 44	100
43612	3/8	9,53	234 x 50	156
43638	1/2	12,70	277 x 89	360
43646	3/4*	19,00	379 x 89	1100

Keys marked * correspond to the metric size.
Above 5/32" A/F they are marked with both sizes.

No. 906QZ

Hexagon keys (inch) with T-grip

Key: CHROM VANADIUM, hardened and **nickel-plated**.
Grip: impact-resistand plastic (cadmium-free) yellow.

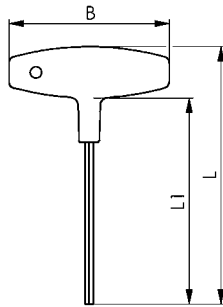

Order no.	A/F [inch]	A/F [mm]	L1	B	L	Weight [g]
45120	5/64*	2,00	100	80	125	28
44883	3/32	2,38	150	80	175	33
44891	1/8	3,18	150	80	175	37
44909	9/64	3,57	150	80	175	42
45252	5/32*	4,00	150	80	175	45
45260	5/32*	4,00	200	80	225	53
44917	3/16	4,76	150	100	182	73
44925	7/32	5,56	150	100	182	82
44933	1/4	6,35	150	100	182	93
45294	5/16*	8,00	150	100	182	120
45310	5/16*	8,00	200	100	232	140

Keys marked * correspond to the metric size.

No. 911-WZ9

Workshop stand (inch)

with inch hexagon keys no. 2936DZ 9-piece set.
Keys: CHROME VANADIUM, hardened and **nickel-plated**.
Edges of end face chamfered.
Stand: plastic-coated **metal**.



Order no.	Contents: A/F	Weight [g]
44057	3/32, 1/8, 5/32, 3/16, 7/32, 1/4, 5/16, 3/8, 1/2"	1010

No. 911HZ 9D

Key holder (inch)

with inch hexagon keys no. 2936DZ, 9-piece set.
 Keys: CHROME VANADIUM, hardened and **nickel-plated**.
 End face machined. Edges of end face chamfered.
 Holder: with slot for self-service rack.



Order no.	Contents: A/F	Weight [g]
44156	1/16, 5/64, 3/32, 1/8, 5/32, 3/16, 3/16, 1/4, 5/16, 3/8"	232

No. 911L-HZ 9D

Key holder (inch)

with inch hexagon keys no. 2936LDZ, **long version** 9-piece set.
 Keys: CHROME VANADIUM, hardened and **nickel-plated**.
 End face machined. Edges of end face chamfered.
 Holder: with slot for self-service rack



Order no.	Contents: A/F	Weight [g]
44164	1/16, 5/64, 3/32, 1/8, 5/32, 3/16, 1/4, 5/16, 3/8"	395

No. 911LG-HZ13D

Key holder, ball-ended (inch)

with ball-ended hexagon keys, **long version**, 13-piece set.
 Keys: CHROME VANADIUM, hardened and **nickel-plated**.
 End face machined. Edges of end face chamfered.
 Holder: with slot for self-service rack.



Order no.	Contents: A/F	Weight [g]
44180	0,05, 1/16, 5/64, 3/32, 7/64, 1/8, 9/64, 5/32, 3/16, 7/32, 1/4, 5/16, 3/8"	440

No. 911BZ7

Key box (inch)

with inch hexagon keys no. 2936DZ, 7-piece set.
 Keys: CHROME VANADIUM, hardened and **nickel-plated**.
 End face machined. Edges of end face chamfered.
 Box: from impact-resistant **plastic** with self-service rack slot.

Order no.	Contents: A/F	L x W x H	Weight [g]
44842	5/64, 3/32, 1/8, 5/32, 3/16, 7/32, 1/4"	133x72x14	140



No. 911TZ

Key wallets (inch)

with inch hexagon keys no. 2936DZ 9, 11 and 14-piece set.
 Keys: CHROME VANADIUM, hardened and **nickel-plated**.
 End face machined. Edges of end face chamfered.
 Plastic wallet with slot for self-service rack and reusable closure.

Order no.	Size	Contents: A/F	Weight [g]
43893	9	0.05, 1/16, 5/64, 3/32, 1/8, 5/32, 3/16, 7/32, 1/4"	100
43901	11	0.05, 1/16, 5/64, 3/32, 1/8, 5/32, 3/16, 7/32, 1/4, 5/16, 3/8"	250
43919	14	0.05, 1/16, 5/64, 3/32, 1/8, 5/32, 3/16, 7/32, 1/4, 5/16, 3/8, 7/16, 1/2, 9/16"	850



TORX® is a registered trademark of Camcar/Textron Inc.

PROFILE

The wave-profile provides a large surface for force and torque transfer
 > optimum grip and long tool-life
 > see table on right for test torques.

MATERIAL

highly alloyed CHROME-VANADIUM steel

EXECUTION AND SURFACE FINISH

> hardened and **steel-grey**
 > hardened and **chromium-plated**

SCREWDRIVERS WITH HANDLE,

for **TORX®**-screws, compliment the well-known advantages of this type of screw.
 > best possible force transfer by handy gripforms.

Table showing **TORX®**-sockets for thread diameters and types of screw.

TORX® Size	A mm	Test torque Nm	Screws with TORX®-sockets								
			metric (M)						Self-tapping (St)		
			DIN 4762 DIN 912	DIN 963 DIN 965	DIN 964 DIN 966	DIN 7984 DIN 6912	DIN 7985	DIN 7991	DIN 7981	DIN 7972 DIN 7982	DIN 7973 DIN 7983
T 6 T 7	1,70 1,99	0,75 1,4	*	*	*	*	*	*	*	*	*
T 8 T 9	2,31 2,50	2,2 2,8	2,5 *	2,5 *	2,5 -	- -	2,5 -	- -	2,9	2,9 -	2,9 -
T10 T15	2,74 3,27	3,7 6,4	3 *	3 3,5	3 3,5	3 -	3 3,5	3 -	3,5 3,9	3,5 3,9	3,5 3,9
T20 T25	3,86 4,43	10,5 15,9	4 5	4 5	4 5	4 5	4 5	4 5	4,2 4,8/5,5	4,2 4,8/5,5	4,2 4,8/5,5
T27 T30	4,99 5,52	22,5 31,1	* 6	* 6	* 6	* 6	* 6	* 6	6,3 *	6,3 *	6,3 *
T40 T45	6,65 7,82	54,1 86,2	8 *	8 *	8 *	8 *	8 *	8 *	- *	- *	- *
T50 T55	8,83 11,22	132 252	10 12	10 -	10 -	10 12	10 -	10 12	- -	- -	- -

* Special screws

No. 908

TORX angled key

CHROM VANADIUM, hardened, **steel-grey**.



Order no.	TORX	A	L1 x L2 [mm]	Weight [g]
46540	T 6	1,70	44,5 x 18,5	1,9
46565	T 7	1,99	50,5 x 18,5	2,0
46581	T 8	2,31	51 x 19	2,8
46607	T 9	2,50	51 x 19	3,4
46615	T10	2,74	54 x 20	3,6
46623	T15	3,27	57,5 x 21,5	5,2
46631	T20	3,86	61 x 23	6,5
46649	T25	4,43	64,5 x 24,5	9,4
46656	T27	4,99	69,5 x 26,5	15
46664	T30	5,52	76 x 30	20
46672	T40	6,65	83 x 33	31
46680	T45	7,82	91 x 37	44
46698	T50	8,83	95 x 32	62
46706	T55	11,22	108 x 35	126

No. 908-TT9

TORX key wallet

with TORX Key no. 908, 9-piece set.
 Keys: CHROME VANADIUM, hardened and **steel-grey**.
 Plastic wallet with slot for self-service rack and reusable closure.

Order no.	Contents TORX	Weight [g]
43836	T6, 7, 8, 9, 10, 15, 20, 25, 30	65



No. 937SH

TORX-PLUS keys with flag-type grip

Blade: CHROME VANADIUM, hardened and **steel-grey**.
Grip: impact-resistant plastic (cadmium-free), light green.



Order no.	TORX	A	L1	B	L	Weight [g]
47464	IP 5	1,42	35	22	69	3,5
47472	IP 6	1,70	35	22	69	3,6
47480	IP 7	1,99	35	22	69	3,7
47498	IP 8	2,31	40	22	74	5,8
47506	IP 9	2,50	40	22	74	6,3
47514	IP10	2,74	40	22	74	6,8
47522	IP15	3,27	45	22	79	7,5
47530	IP20	3,86	45	22	79	8,0

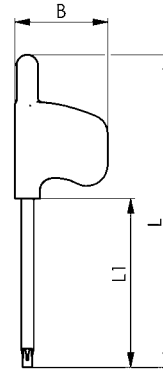

No. 907SH

TORX keys with flag-type grip

Blade: CHROME-VANADIUM, hardened and **steel-grey**.
Grip: impact-resistant plastic (cadmium-free), green.



Order no.	TORX	A	L1	B	L	Weight [g]
46185	T5	1,42	35	22	69	3,5
46847	T6	1,70	35	22	69	3,6
46854	T7	1,99	35	22	69	3,7
46862	T8	2,31	40	22	74	5,8
46870	T9	2,50	40	22	74	6,3
46888	T10	2,74	40	22	74	6,8
46896	T15	3,27	45	22	79	7,5
46987	T20	3,86	45	22	79	8,0

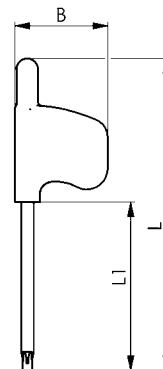

No. 907S

TORX key with small grip

Blade: CHROME-VANADIUM, hardened and **steel-grey**.
Grip: impact-resistant plastic (cadmium-free), green.



Order no.	TORX	A	L1	B	L	Weight [g]
46730	T 6	1,70	35	38	70	14
46748	T 7	1,99	35	38	70	14
46755	T 8	2,31	40	38	75	14
46763	T 9	2,50	40	38	75	15
46771	T10	2,74	40	38	75	15

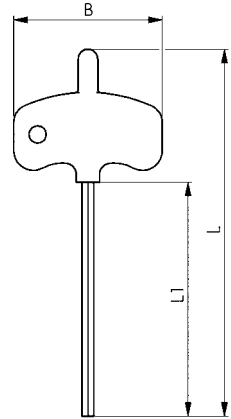

No. 907LE

TORX key with ergonomic 2-component screwdriver grip

Blade: CHROME-VANADIUM, hardened and **chromium-plated** with black tip.
Grip: impact-resistant plastic (cadmium-free), black/green.



Order no.	TORX	A	L1	L	Weight [g]
47407	T 8	2,31	60	140	37
47415	T 9	2,50	60	140	37
47423	T10	2,74	80	160	39
47431	T15	3,27	80	170	41
47449	T20	3,86	100	190	56
47456	T25	4,43	100	200	60

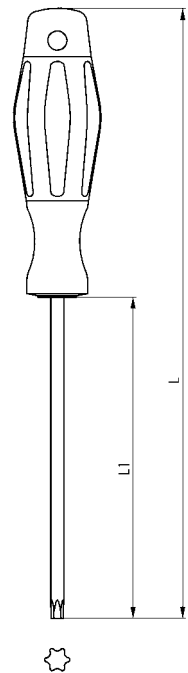

No. 907Q TORX key with T-grip

Blade: CHROME-VANADIUM, hardened and **chromium-plated** with black tip.
Grip: impact-resistant plastic (cadmium-free), green.

Order no.	TORX	A	B	L	L1	Weight [g]
45906	T 9	2,50	80	125	100	35
45914	T10	2,74	80	125	100	35
45922	T15	3,27	80	125	100	36
45930	T20	3,86	100	125	100	60
45948	T25	4,43	100	125	100	60
45955	T27	4,99	100	131	100	70
45963	T30	5,52	100	131	100	75
45989	T40	6,65	100	131	100	80
46029	T50	8,83	120	188	150	160

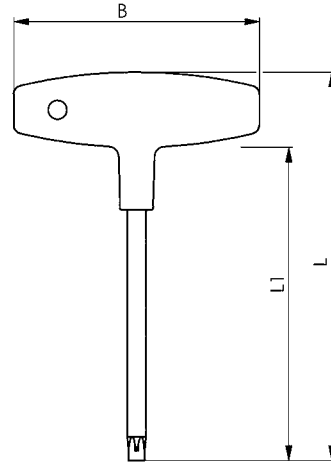

No. 907Q-WT7 TORX workshop stand

with T-grip TORX key no. 907Q, 7-piece set.
Blades: CHROME-VANADIUM, hardened and **chromium-plated** with black tip.
Grip: impact-resistant **plastic** (cadmium-free), green.
Stand: single-grade, impact-resistant plastic with clips for connecting further workshop stands.

Order no.	Contents: TORX x blade length L1	Weight [g]
46722	T10x100, T15x100, T20x100, T25x100, T30x100, T40x100, T50x150	660



Space for two additional TORX keys

No. 909ET8

TORX SCHRAUB-BOY

Body: from ergonomic 2-component housing.
lift mechanism offers convenient access to the blades.
 Blades: CHROME VANADIUM, hardened and **steel-grey**.



Order no.	Contents TORX	Weight [g]
45658	T9, 10, 15, 20, 25, 27, 30, 40	210

No. 908L-HT13C

TORX key holder

with TORX keys, long, 13-piece set.
 Keys: CHROME VANADIUM, hardened and **steel-grey**.
 Holder: with slot for self-service rack.



Order no.	Contents TORX	Weight [g]
45369	T5, 6, 7, 8, 9, 10, 15, 20, 25, 27, 30, 40, 50	440

No. 918-HT8C

Ball-ended TORX hexagon key

with TORX ball-ended hexagon keys, 8-piece set.
 Keys: CHROME VANADIUM, hardened and **steel-grey**.
 Holder: with slot for self-service rack.



Order no.	Contents TORX	Weight [g]
48900	T9, 10, 15, 20, 25, 27, 30, 40	165

TOOLS FOR THREADED FASTENERS FOR TRADE AND INDUSTRY.

Troughout the world, AMF is a hallmark for high-quality screwdriving tools for tradespeople and industry. Our products prove themselves millions of times every day.

FROM DIN TO COMPANY STANDARDS.

Technical perfection is our standard. The results of this quality: a long working-life, precise transmission of force and thus the greatest possible safety, and user-friendliness in every detail. From socket wrenches to hook wrenches, from pin wrenches to open-ended spanners, from drill drift to fire hydrant key, we have a broad and balanced program of screwdriving tools. Made of alloy steels with appropriate plated finishes for all applications. The following pages will give you an overview of this wide spectrum.

MADE-TO-MEASURE, FROM SMALL TO ENORMOUS.

One of our specialities is the manufacturer of special tools to customers' individual requirements. Special tools can also be made from existing ones but modified to meet your requirements. A drawing or sketch and the quantity required are all the information we need to quote.



APPLICATIONS AND SIZE RANGES HOOK WRENCHES DIN 1810A (PAGE 40)

Size	DIN1804	DIN981			DIN70852	DIN11851-F
	M	M	KM	KML	M	DN
12 - 14	-	-	-	-	-	-
16 - 20	6 8	-	-	-	10	-
25 - 28	10 12	15 17	2 3	-	16	-
30 - 32	14 16	20	4	-	18 20	-
34 - 36	18 20	-	-	-	22	-
38 - 45	26	25 30	5 6	-	24 - 30	10 15
40 - 42	22 24	-	-	-	26 28	-
45 - 50	26 - 30	30	6	-	32 35	-
52 - 55	32 35	35	7	-	38	20
58 - 62	38 - 42	40	8	-	42 45	25
65 - 70	-	45 50	9 10	-	48 - 52	32
68 - 75	45 - 50	55	11	-	50 - 55	32
80 - 90	52 - 60	60	12	-	60 - 70	-
85 - 92	-	65 70	13 14	-	65 70	50
95 - 100	62 - 70	-	-	-	75 80	-

Size	DIN1804	DIN981			DIN70852	DIN11851-F
	M	M	KM	KML	M	DN
98 - 105	-	75 80	15 16	-	80	-
110 - 115	72 - 80	85	17	-	90	65
120 - 130	85 90	100	20	-	100 105	80
135 - 145	95 100	110 120	22 -	- 24	110 115	-
155 - 165	105 - 120	120 130 140	24 26 -	- 26 28	125 - 135	-
180 - 195	125 - 140	140 150	28 30	- 30	150 - 160	-
205 - 220	150 160	170 190	34 -	- 38	175 180	150
230 - 245	170 180	180	36	-	190 - 200	-
260 - 270	190 200	-	-	-	-	-
280 - 300	-	-	-	-	-	-
300 - 320	-	-	-	-	-	-
320 - 345	-	-	-	-	-	-
350 - 375	-	-	-	-	-	-
380 - 400	-	-	-	-	-	-
480 - 500	-	-	-	-	-	-

ADJUSTABLE HOOK WRENCHES WITH NOSE NO. 771C AND NO. 771MD (PAGE 46)

Size	DIN 1804	M	DIN 981		DIN 11851-F DN
	M		KM	KML	
20 - 42	8 - 24	15 - 25	2 - 5	-	10
45 - 90	26 - 60	30 - 65	6 - 13	-	15 - 50
95 - 165	62 - 120	75 - 130	15 - 26	-	65 - 100
		120	-	24	
		130	-	26	
		140	--	28	



HOOK WRENCHES NO. 775 (PAGE 42, 44)

Size	DIN 1804	M	DIN 981		DIN 11851-F DN	DIN 70852 M
	M		KM	KML		
20 - 35	8 - 18	15 - 20	2 - 4	-	-	10 - 20
35 - 60	20 - 38	25 - 40	5 - 8	-	10 - 20	22 - 42
60 - 90	40 - 60	45 - 65	9 - 13	-	25 - 40	42 - 70
90 - 155	58 - 110	70 - 115	14 - 23	-	50 - 100	70 - 125
		120	24	24		
		130	-	26		
155 - 230	105 - 170	120 - 180	24 - 36	-	125 - 150	125 - 190
		130, 140, 150	-	26, 28, 30		
		160, 170, 180, 190	-	32, 34, 36, 38		

HOOK WRENCHES DIN 1810B AND NO. 776 (PAGE 41, 43, 45, 46)

1810B Size	DIN 1816 M	776 Size	1810B Size	DIN 1816 M	776 Size	1810B Size	DIN 1816 M	776 Size
16 - 18	6	16 - 22	58 - 62	42	60 - 90	135 - 145	95	95 - 155
20 - 22	8	22 - 35		45			100	
25 - 28	10		80 - 90	48			105	
	12			50		110		
30 - 32	14		95 - 100	52		115		
	16			55		120		
34 - 36	18		110 - 115	58		125		
	20	60		130				
40 - 42	22	120 - 130	62	165 - 230				
	24		95 - 155			65		
45 - 50	26	68			205 - 220	140		
	28	70	150					
	30	72	160					
52 - 55	32	110 - 115	75		230 - 245	170	-	
	35		80			180	-	
58 - 62	38	120 - 130	85		260 - 270	190	-	
	40		90			200	-	

DIN 1810A

Hook wrench with nose

for grooved nuts to DIN 1804 and bearing nuts to DIN 981.
Special steel, machined nose, edges ground, hardened and **blued**.
Rounded edges for better handling.

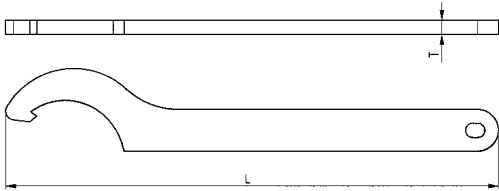

Order no.	Size	L	T	Weight [g]
54585	12- 14	110	3	25
54593	16- 20	110	3	25
54601	25- 28	136	4	45
54619	30- 32	136	4	50
54627	34- 36	170	5	90
54387	(38- 45)	170	5	95
54635	40- 42	170	5	90
54643	45- 50	206	6	155
54650	52- 55	206	6	160
54668	58- 62	240	7	260
54403	(65- 70)	240	7	255
54676	68- 75	240	7	255
54684	80- 90	280	8	410
54429	(85- 92)	280	8	410
54692	95-100	280	8	405
54445	(98-105)	290	8	405
54700	110-115	335	10	745
54718	120-130	335	10	720
54726	135-145	385	10*	1000
54734	155-165	385	10*	965
54742	180-195	470	10*	1500
54759	205-220	470	10*	1580
54767	230-245	568	10*	2250
54775	260-270	568	10*	2250
54783	280-300	680	15	5150
54841	300-320	695	15	5100
54791	320-345	695	15	5200
54809	350-375	735	15	5200
54817	380-400	770	15	6700
54825	480-500	988	20	13000

* Thickness not to DIN () DIN extended

On request:

Intermediate sizes and other material thicknesses for quantities above 100 on request. Available in stainless steel on request (up to 6 mm thick).

DIN 1810AD

Hook wrench with nose

for grooved nuts to DIN 1804 and bearing nuts to DIN 981.
Special steel, machined nose, edges ground, hardened and **high-grade zinc-plated**.
Rounded edges for better handling.

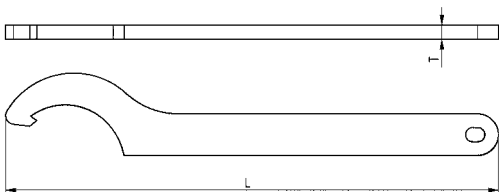

Order no.	Size	L	T	Weight [g]
55103	16- 20	110	3	25
55111	25- 28	136	4	45
55129	30- 32	136	4	50
55137	34- 36	170	5	90
55152	40- 42	170	5	90
55160	45- 50	206	6	155
55178	52- 55	206	6	160
55186	58- 62	240	7	260
55202	68- 75	240	7	255
55210	80- 90	280	8	410
55236	95-100	280	8	405
55251	110-115	335	10	745
55269	120-130	335	10	720
55277	135-145	385	10*	1000
55285	155-165	385	10*	965

* Thickness not to DIN

DIN 1810B

Hook wrench with pin

for nuts with radial holes to DIN 1816.
Special steel, hardened and **blued**.
Rounded edges for better handling.

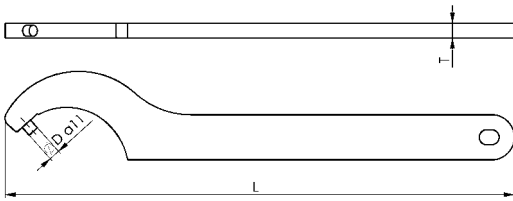

Order no.	Size	Pin dia.	L	T	Weight [g]
54874	12- 14	2,0	110	3	25
54882	16- 18	2,5	110	3	25
54890	20- 22	2,5	110	3	25
54908	25- 28	3	136	4	55
54916	30- 32	4	136	4	55
54924	34- 36	4	170	5	100
54932	40- 42	4	170	5	100
54940	45- 50	5	206	6	165
54957	52- 55	5	206	6	165
54965	58- 62	5	240	7	270
54973	68- 75	6	240	7	270
54981	80- 90	6	280	8	410
54999	95-100	8	280	8	410
55004	110-115	8	335	8*	610
55012	120-130	8	335	8*	610
55020	135-145	8	380	8*	790
55038	155-165	8	380	8*	790
55046	180-195	10	470	10*	1500
55053	205-220	10	470	10*	1580
55061	230-245	10	568	10*	2250
55079	260-270	10	568	10*	2250

* Thickness not to DIN (..) similar DIN.

On request:

Intermediate sizes or other pin diameters for quantities above 100 on request. Available in stainless steel on request (up to 6 mm thick).

DIN 1810BD

Hook wrench with pin

for nuts with radial holes to DIN 1816.
Special steel, hardened and **high-grade zinc-plated**.
Rounded edges for better handling.

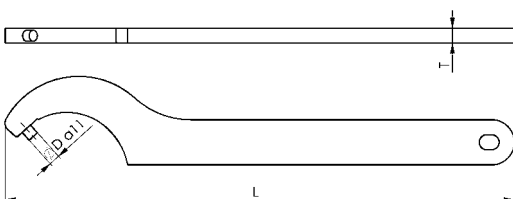

Order no.	Size	Pin dia.	L	T	Weight [g]
55400	16- 18	2,5	110	3	25
55418	20- 22	2,5	110	3	25
55426	25- 28	3	136	4	55
55434	30- 32	4	136	4	55
55442	34- 36	4	170	5	100
55459	40- 42	4	170	5	100
55467	45- 50	5	206	6	165
55475	52- 55	5	206	6	165
55483	58- 62	5	240	7	270
55491	68- 75	6	240	7	270
55509	80- 90	6	280	8	410
55517	95-100	8	280	8	410
55525	110-115	8	335	8*	630
55533	120-130	8	335	8*	630
55541	135-145	8	380	8*	800
55558	155-165	8	380	8*	800

* Thickness not to DIN

ASSEMBLY VERSION

Benefits:

- > **Lightweight** keys, for frequent actuation, reduced fatigue
- > **Short** version, fits into every pocket and toolbox

No. 775SC

Hinged hook wrench with nose, assembly version

for grooved nuts to DIN 1804 and bearing nuts to DIN 981.
Special steel, hardened and **blued**.
Rounded edges for better handling.

Order no.	Size	L	T	T1	Weight [g]
56697	20-35	135	3	8	40
56705	35-60	175	4	11	85
56713	60-90	240	6	13	250
56721	90-155	300	7	15	425
56739	155-230	420	8	18	1015

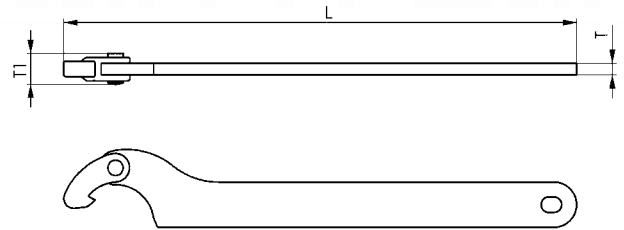

No. 775SNI

Hinged hook wrench with nose, assembly version, stainless steel

for grooved nuts to DIN 1804, bearing nuts to DIN 981
and for couplings and fittings to DIN 11851.
Stainless steel.

Rounded edges for better handling.



Order no.	Size	L	T	T1	Weight [g]
56796	20-35	135	3	8	35
56804	35-60	175	4	11	75
56812	60-90	240	5	13	185
56820	90-155	300	6	15	320
56838	155-230	420	8	18	860

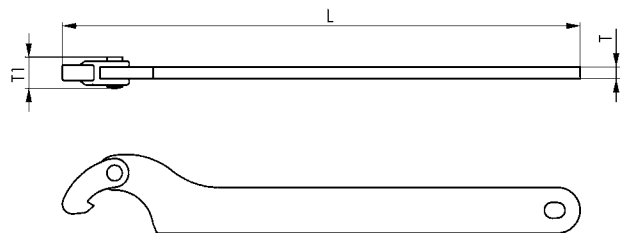

ASSEMBLY VERSION

Benefits:

- > **Lightweight** keys, for frequent actuation, reduced fatigue
- > **Short** version, fits into every pocket and toolbox
- > All common pin diameters available.

No. 776SC

Hinged hook wrench with pin, assembly version

for nuts with radial holes to DIN 1816.

Special steel, hardened and **blued**.

Rounded edges for better handling.

Order no.	Size	D	L	T	T1	Weight [g]
51821	20-35	2,5*	135	3	8	40
51839	20-35	3,0	135	3	8	40
51847	20-35	4,0	135	3	8	40
51854	35-60	4,0*	175	4	11	85
51862	35-60	5,0	175	4	11	85
51870	60-90	5,0*	245	6	13	250
51888	60-90	6,0	245	6	13	250
51896	90-155	6,0*	300	7	15	425
51904	90-155	8,0	300	7	15	425
51912	155-230	8,0	420	8	18	1015

* If no pin diameter is given in the order, we supply the pin diameter marked with a *.

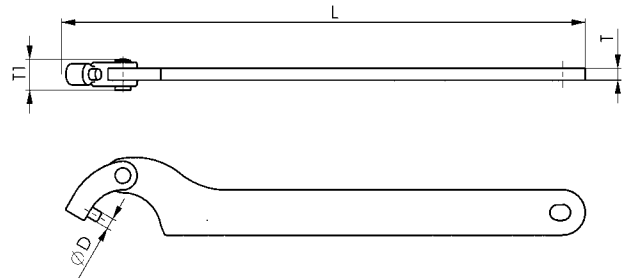

Specifications subject to change.

INDUSTRIAL VERSION

Benefits:

- > Longer shank for increased torque
- > Extended hook for greater contact and safer use
- > Strengthened rivet increases working life and permits transmission of greater forces, especially with smaller sizes
- > Even movement due to additional spring washer, one-handed operation possible

No. 775C

Hinged hook wrench with nose, industrial version

for grooved nuts to DIN 1804 and bearing nuts to DIN 981. Special steel, hardened and **blued**. With hole for hanging up. Extended hook and shank, strengthened rivet, spring washer. **Rounded edges for better handling.**

Order no.	Size	L	T	T1	Weight [g]
51649	20-35	165	4	10,5	85
51656	35-60	210	5	12,5	170
51664	60-90	280	6	14,5	360
51672	90-155	335	7	17,5	610
51680	155-230	460	8	17,5	1200

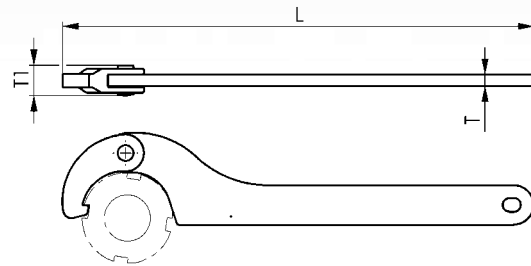

No. 775D

Hinged hook wrench with nose, industrial version

for grooved nuts to DIN 1804 and bearing nuts to DIN 981. Special steel, edges ground, hardened and **nickel-plated**. With hole for hanging up. Extended hook and shank, strengthened rivet, spring washer. **Rounded edges for better handling.**

Order no.	Size	L	T	T1	Weight [g]
51730	20-35	165	4	10,5	85
51748	35-60	210	5	12,5	170
51755	60-90	280	6	14,5	360
51763	90-155	335	7	17,5	610
51771	155-230	460	8	17,5	1200

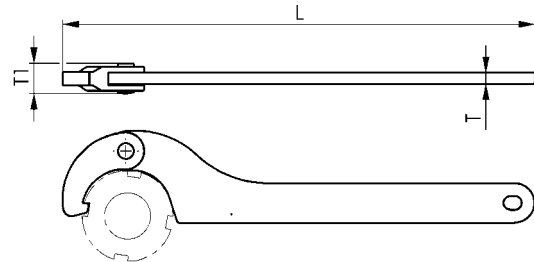

No. 775NI

Hinged hook wrench with nose, industrial version, stainless steel

for grooved nuts to DIN 1804, bearing nuts to DIN 981 and for couplings and fittings to DIN 11851. **Stainless steel**. With hole for hanging up. Extended hook and shank, strengthened rivet, spring washer. **Rounded edges for better handling.**

Order no.	Size	L	T	T1	Weight [g]
52183	20-35	165	4	10,5	85
52191	35-60	210	5	12,5	170
52209	60-90	280	6	14,5	360
52217	90-155	335	6	17,5	580
52225	155-230	460	8	17,5	1200

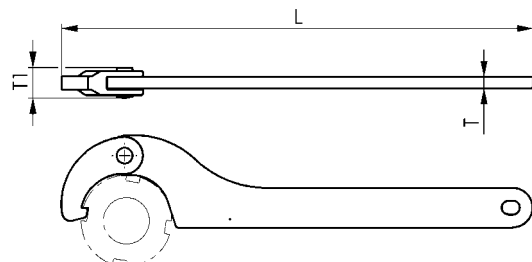

Specifications subject to change.

INDUSTRIAL VERSION

Benefits:

- > Longer shank for increased torque
- > Extended hook for greater contact and safer use
- > Strengthened rivet increases working life and permits transmission of greater forces, especially with smaller sizes
- > Even movement due to additional spring washer, one-handed operation possible
- > Improved ratio of pin diameter to nut diameters

No. 776C

Hinged hook wrench with pin, industrial version

for nuts with radial holes to DIN 1816.

Special steel, hardened and **blued**.

With hole for hanging up. Extended hook and shank, strengthened rivet, spring washer and optimised radial areas.

Rounded edges for better handling.



Order no.	Size	D	L	T	T1	Weight [g]
53058	16-22	2,5	135	3	7,5	50
53066	22-35	3,0	165	4	10,5	85
53074	35-60	4,0	205	5	12,5	170
53181	60-90	5,0*	280	6	14,5	380
53082	60-90	6,0	280	6	14,5	380
53090	95-155	6,0*	335	7	17,5	610
53199	95-155	8,0	335	7	17,5	610
53173	165-230	8,0	460	8	17,5	1200
53108	165-230	10,0*	460	8	17,5	1200

* If no pin diameter is given in the order, we supply the pin diameter marked with a *.
Sizes 16-22 without retaining ring.

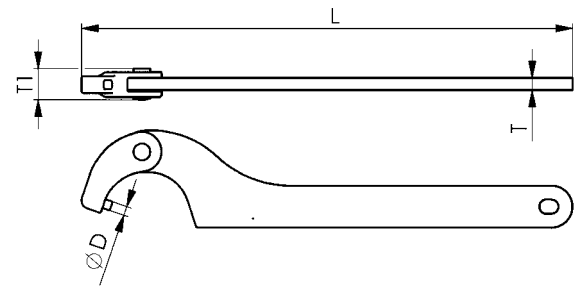

No. 776D

Hinged hook wrench with pin, industrial version

for grooved nuts to DIN 1816.

Special steel, hardened and **nickel-plated**.

With hole for hanging up. Extended hook and shank, strengthened rivet, spring washer and optimised radial areas.

Rounded edges for better handling.



Order no.	Size	D	L	T	T1	Weight [g]
53116	16-22	2,5	135	3	7,5	50
53124	22-35	3,0	165	4	10,5	85
53132	35-60	4,0	205	5	12,5	170
53140	60-90	6,0	280	6	14,5	380
53157	95-155	6,0	335	7	17,5	610
53165	165-230	10,0	460	8	17,5	1200

Sizes 16-22 without retaining ring.

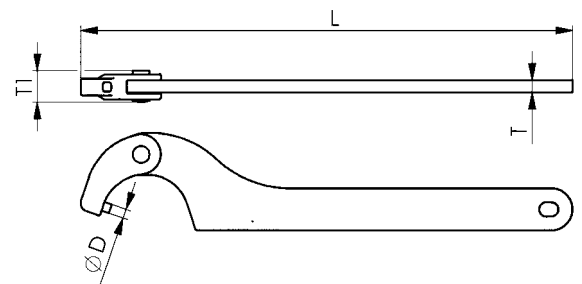

No. 771C

Adjustable hook wrench with nose

for grooved nuts to DIN 1804 and bearing nuts to DIN 981.
Special steel, hardened and **blued**. Rounded edges for better handling.



Order no.	Size	L	T	Weight [g]
51201	20-42	180	4	100
51219	45-90	240	6	250
51227	95-165	335	10	710

No. 771Md

Adjustable hook wrench with nose and torque socket

for grooved nuts to DIN 1804 and bearing nuts to DIN 981.
Special steel, hardened and **blued**. Drive: square socket



Order no.	Size	Drive SW [inch]	L	S	T	T1	Weight [g]
51516	20-42	1/2	135	100	4	16,0	165
51532	45-90	1/2	192	150	6	16,0	310
51557	95-165	3/4	298	220	10	20,5	910

Note:

The set value for the torque wrench is dependant on insertion dimension „S“.
The operating manual provided with your torque wrench contains the requisite information and calculation formulae.

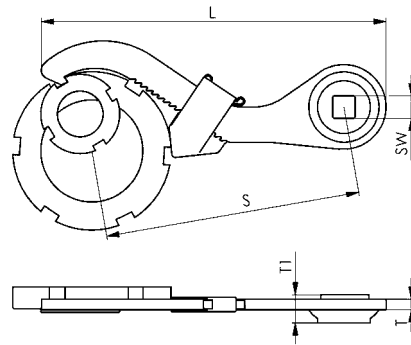

No. 776Md

Hinged hook wrench with pin and torque-wrench socket

For nuts with radial holes to DIN 1816.
Special steel, hardened and **blued**. Drive: square socket

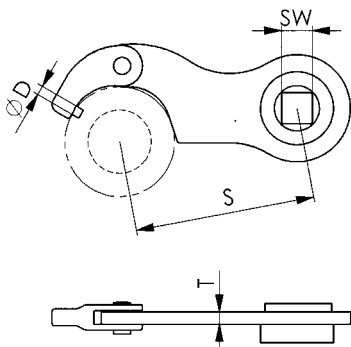

Order no.	Size	Drive SW [inch]	D	S	T	Weight [g]
52753	35-60	1/2	4	75	5	185
52761	60-90	1/2	6	100	6	320

Note:

The set value for the torque wrench is dependant on insertion dimension „S“.
The operating manual provided with your torque wrench contains the requisite information and calculation formulae.



Specifications subject to change.

DIN 14822

Coupling wrench for fire hydrant couplings

Case-hardened steel, zinc-plated. All sharp edges broken. Grip with cold protection. Stamped DIN 14822-ABC (or BC).



Order no.	Form	Lug spacing	for Storz	L	A	B	Weight [g]
45344	ABC	66-133	52-75-110	400	25	8	685
45336	BC	66-89	52-65-75	280	20	6	290

On request:

Special versions to old standard.

Form ABC

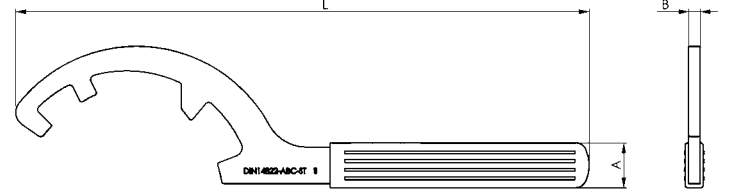

Form BC

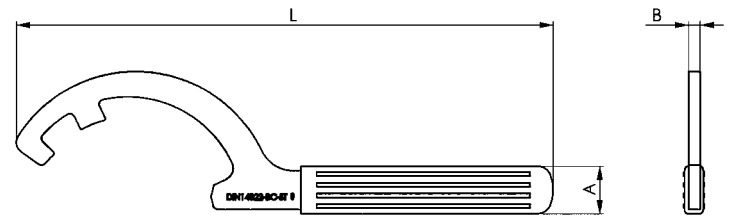

No. 14822

Special-Coupling wrench for fire hydrant couplings

On request, we can supply special versions.

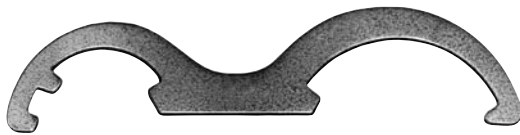

Special version!

Form ABC

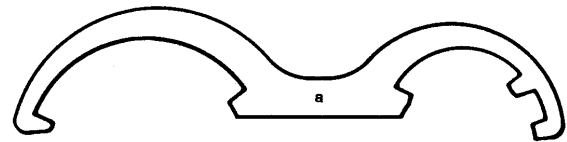

Form BC



Form C



Specifications subject to change.

No. 758S

Adjustable face spanner set

with replaceable, hardened pin in two-component box, black-orange.
Keys: Special steel, **zinc-plated**.



Order no.	A	Pin dia.	Box L x B x H	Weight [g]
50427	8-100	1,5, 2, 2,5, 3, 4	165 x 87 x 36	335

Application:

Ideal for mechanics, maintenance and service technicians, at the workbench and for do-it-yourselfers.

Advantage:

The adjustable face spanner set replaces 5 individual key sizes. The exchangeable pins (2 per size) are clearly stored in 2 separate boxes. The robust 2-component box protects the keys and the pins, and everything is always accessible.

No. 756-760

Adjustable pin wrench for nuts with 2 holes

No.756 with riveted pins,
from no. 758 with pins electrically welded. Special steel, **blued**.



Order no.	Article no.	A	dia. D*	L1	L	T	Weight [g]
40477	756	7 - 40	1,5	2	115	3	40
40485	756	7 - 40	2,0	2,5	115	3	40
40493	756	7 - 40	2,5	3	115	3	40
40618	758	11 - 60	3	4	160	4	140
40626	758	11 - 60	4	5	160	4	140
40634	758	11 - 60	5	6	160	4	140
40758	759	14 - 100	5	6	215	6	300
40766	759	14 - 100	6	7	215	6	300
40774	759	14 - 100	8	8	215	6	300
40899	760	22 - 125	8	8	260	6	500
40907	760	22 - 125	10	10	260	6	500
40915	760	22 - 125	12	12	260	6	500

* Pin diameter = nominal diameter -0.1mm (tolerance class h₁₂).

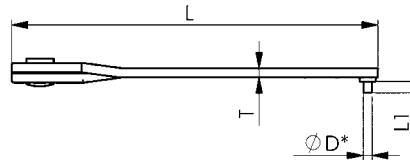
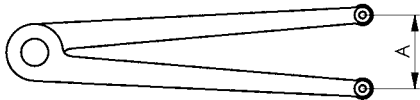

No. 758-759CC

Adjustable pin wrench for nuts with 2 holes, cranked

with electrically welded pins. Special steel, hardened and **blued**.



Order no.	Article no.	A	dia. D*	L	T	T1	Weight [g]
50914	758CC	11-60	3	153	4	20	120
50922	758CC	11-60	4	153	4	20	120
50930	759CC	14-90	5	205	6	27	310
50948	759CC	14-90	6	205	6	27	310

* Pin diameter = nominal diameter -0.1mm (tolerance class h₁₂).

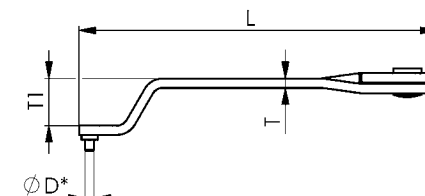
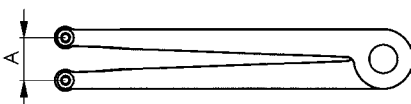

No. 764C

Hinged pin wrench for nuts with 2 holes

with electrically welded pins.
With hole for hanging up. Special steel, **blued**.

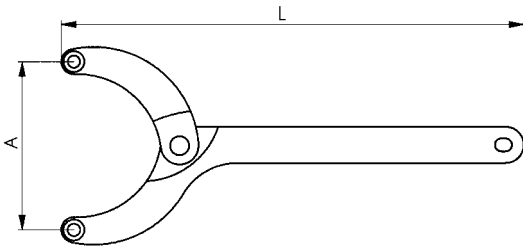

Order no.	A	dia. D*	L	L1	T	Weight [g]
41038	18-40	3	150	4	5	90
41046	18-40	4	150	5	5	90
41053	40-80	4	220	5	6	245
41061	40-80	5	220	6	6	245
41079	40-80	6	220	7	6	245
41087	80-125	6	295	7	8	615
41095	80-125	7	295	7,5	8	615
41103	80-125	8	295	8	8	615
41111	125-200	8	405	8	10	1530
41129	125-200	10	405	10	10	1530

* Pin diameter = nominal diameter -0.1 mm (tolerance class h₁₂)

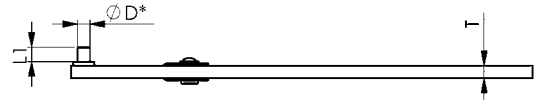

No. 764AZ

Hinged pin wrench for nuts with 2 holes

with replaceable, hardened pins (version AZ), fully assembled.
With hole for hanging up. Special steel, **blued**.

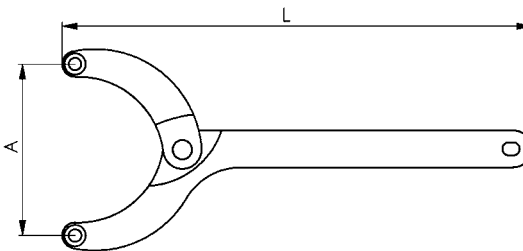

Order no.	A	dia. D*	L	L1	T	Weight [g]
40998	18-40	3	150	4	5	90
41004	18-40	4	150	5	5	90
41012	40-80	4	220	5	6	245
41020	40-80	5	220	6	6	245
41137	40-80	6	220	7	6	245
41145	80-125	6	295	7	8	615
41152	80-125	7	295	7,5	8	615
41160	80-125	8	295	8	8	615
41277	125-200	8	405	8	10	1530
41285	125-200	10	405	10	10	1530

* Pin diameter = nominal diameter -0,1 mm (tolerance class h₁₂)

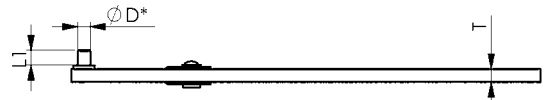

No. 764AZ4

Loose pin with nut

for nos. 758AZ, 759AZ and 764AZ pin wrenches with replaceable pins. Special steel, hardened and **blued**.



Order no.	Usage 758AZ	Usage 759AZ	Usage 764AZ	dia. D*	L	M
47795	11-60	-	18-40	3	4	M 4
47803	11-60	-	18-40	4	5	M 4
47779	11-60	-	-	5	6	M 4
47811	-	-	40-80	4	5	M 5
47829	-	-	40-80	5	6	M 5
47837	-	-	40-80	6	7	M 5
47787	-	14-100	-	5	6	M 6
47845	-	14-100	80-125	6	7	M 6
47852	-	-	80-125	7	7,5	M 6
47860	-	14-100	80-125	8	8	M 6
47878	-	-	125-200	8	8	M 8
47886	-	-	125-200	10	10	M 8

* Pin diameter = nominal diameter -0.1 mm (tolerance class h₁₂)

DIN 3116

Wrench for 2 hole nuts

Special steel, **zinc-plated**. With electrically welded pins.

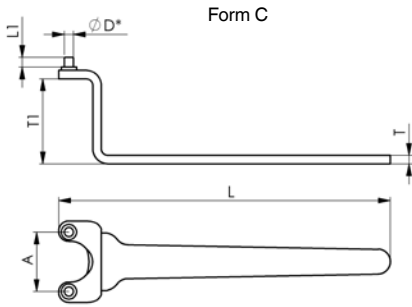

Order no.	Form	A	dia. D*	L	L1	T	T1	Weight [g]
50997	A	30	4	164	5	4	-	85
44685	A	35	5	180	(6)	5	-	120
44669	C	35	(5)	200	6	5	50	200

* Pin diameter = nominal diameter -0.1 mm (tolerance class h_{12})
() DIN extended

Application:

Size 35 for flange nut DIN 44716-D of angle grinder DIN 44706 for clamping grinding and cutting-off wheels.

Form A

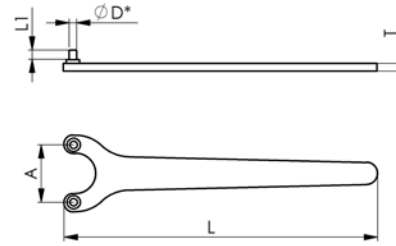

DIN 3116A

Wrench for 2 hole nuts

Special steel, **blued**. With electrically welded pins.

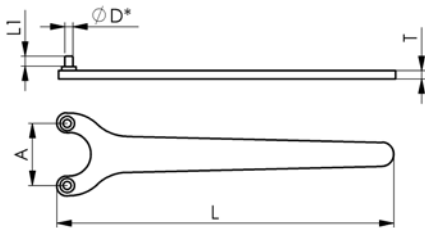

Order no.	A	dia. D*	L	L1	T	Weight [g]
44453	13	2,5	90	3	3	27
44461	15	3	90	4	3	27
44479	20	(3)	122	4	4	50
44628	20	4	122	5	4	50
44636	25	3	137	4	4	65
44487	25	(4)	137	5	4	65
44495	30	4	164	5	4	85
44503	35	(4)	180	5	5	120
44644	35 **	5	180	6	5	120
44511	40	4	167	5	5	120
44529	45	4	187	5	5	145
44537	50	5	198	6	5	175
44545	60	5	213	6	6	220
44552	75	6	243	7	6	330
44560	90	7	270	7,5	6	410

* Pin diameter = nominal diameter -0.1 mm (tolerance class h_{12})
** Standard size for commercially available angle-grinders and cutters.

() DIN extended

Note:

Size 13 has riveted pins.

Sizes 13 and 15 without cut-out between pins for M8 and M10 nuts to DIN 547.

On request:

Zinc-plated on request.

DIN 3116C

Wrench for 2 hole nuts

Special steel, **blued**. With electrically welded pins.

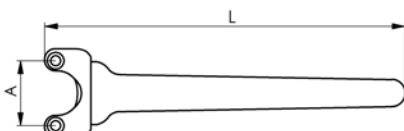

Order no.	A	dia. D*	L	L1	T	T1	Weight [g]
44651	18	3	140	4	4	15	95

* Pin diameter = nominal diameter -0.1 mm (tolerance class h_{12})

Note:

This wrench is used for adjusting timing belt tensioners (AUDI, VW).

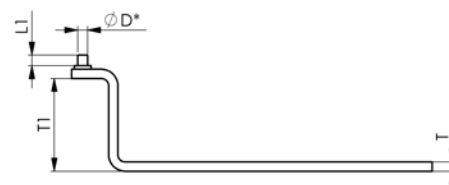

Specifications subject to change.

No. 250Md

Key for collet chuck with torque-wrench socket

for chuck nuts (ER) to DIN 6499.
 Drive 1/2" square socket with ball-engagement groove.
 Special steel, hardened and zinc-plated.



Order no.	Size	D	L	S	T	Weight [g]
52316	16	32	69	45	5	180
52308	25	42	85	60	6	200
52324	32	50	85	60	6	210
52340	40	63	85	60	6	220

Advantage:

Controlled tightening prevents damage to spindle changing tools on a machine.

Note:

The set value for the torque wrench is dependant on insertion dimension „S“.
 The operating manual provided with your torque wrench contains the requisite information and calculation formulae.

On request:

Other sizes available.

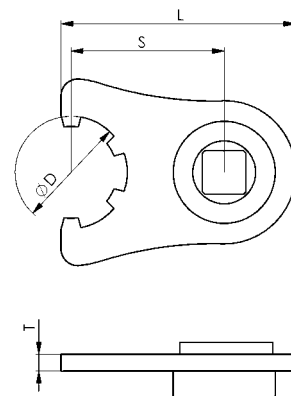

No. 902Md

Open-ended spanner with torque-wrench socket

for clamping nuts.
 Drive 1/2" square socket with ball-engagement groove.
 Special steel, hardened and zinc-plated.



Order no.	SW	L	S	SW1 [Inch]	T	T1	Weight [g]
52506	25	78	45	1/2	6	16	170
52514	36	101	60	1/2	7	16	255
52522	46	108	60	1/2	8	16	340

Advantage:

Controlled tightening prevents damage to spindle changing tools on a machine.

Note:

The set value for the torque wrench is dependant on insertion dimension „S“.
 The operating manual provided with your torque wrench contains the requisite information and calculation formulae.

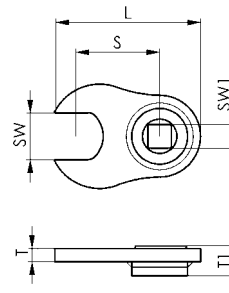

DIN 317

Drill drift

Special steel, hardened and **blued**.

Order no.	Size	for tapers Morse	for tapers Metric	B x T	L	Weight [g]
40147	0	0	4 + 6	12x 3	90	14
40154	1	1 + 2	-	20x 5	140	70
40162	3	3	-	25x 7	190	150
40170	4	4	-	30x10	225	310
40188	5	5 + 6	-	35x15	265	650

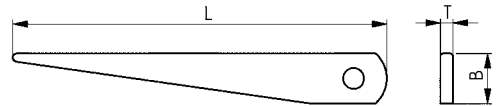

No. 318

Drill drift, semi-automatic for morse tapers

Special steel, hardened and **blued**.

Grip: plastic-coated, red. With finger protection!!

Order no.	Size	for tapers Morse	Length [mm]	Weight [g]
40220	1 - 3	1 - 3	330	370
40238	4 - 6	4 - 6	380	530

Advantage:

- With finger protection (Gr. 1-3)
- One-hand operation.
- Pressure on the lever moves a gear rack between two opposing wedges (the other hand holds the tool to prevent it falling).
- Releasing tools using the **semi-automatic drift** helps prevent spindle damage.



DIN 22417A

Triangular socket spanner

Special steel. Body and tommy bar, zinc-plated.



Order no.	Size	L1 x D1	L2 x D2	S	Weight [g]
44354	M 4	90x10	50x 6	6,80	20
44362	M 5	100x12	65x 6	8,30	30
44370	M 6	115x14	80x 6	10,05	60
44388	M 8	125x16	100x 8	12,05	80
44396	M10	140x20	125x 8	15,05	160
44404	M12	160x22	160x10	16,55	240
44412	M16	180x25	200x12	20,55	400

*The size refers to the screw diameter.

Application:

These spanners are intended for triangular-head screws to DIN 22424 and nuts to DIN 22425. The M12 size is especially suitable for installing and removing steel and aluminium access-denial posts.

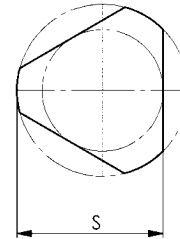

DIN 905

Screwdriver for square drive bolts

Special steel, body and tommy bar hardened and blued. Tommy bar pressed in.

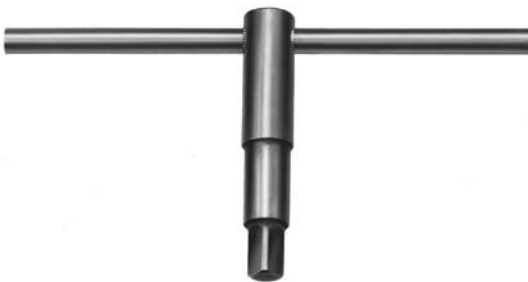

Order no.	SW	D1	D2	D3	L1	L2	L3	L4	Weight [g]
41988	(4)	12,0	6,0	6	60	160	20	9	70
41996	5	12,0	6,0	8	60	160	20	11	70
42002	6	12,0	6,0	10	80	160	22	12	80
42010	(7)	14,6	6,0	12	80	160	26	15	115
42028	8	16,0	9,0	14	80	180	26	15	180
42036	9	16,0	9,0	14	80	180	26	17	180
42044	10	20,0	11,0	18	100	200	30	18	320
42051	11	20,0	11,0	18	100	200	30	20	320
42069	12	24,0	12,0	20	100	250	38	21	450
42077	13	24,0	12,0	20	100	250	38	22	450
42085	14	28,0	14,6	22	120	320	38	24	780
42093	17	34,0	16,0	25	160	400	50	28	1500
42101	19	36,0	16,0	28	200	400	50	30	1850
42119	22	42,0	20,0	32	200	630	65	34	3100

() DIN extended

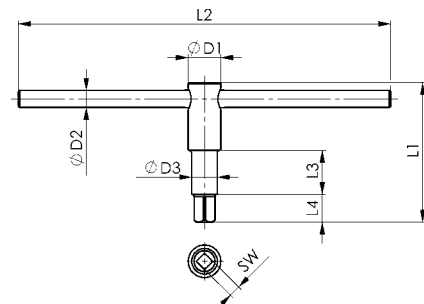

DIN 7417

Square socket key

Die-cast zinc, galvanised.

Order no.	SW	D	L	Weight [g]
56002	6	11	55	18
56010	7	12	52	18
56028	8	14	58	24
56044	10*	17	68	40

* similar to DIN.

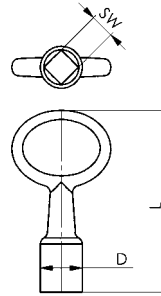

No. 914Q

Square socket spanner with T-grip

Blade: CHROME VANADIUM, hardened and nickel-plated.

Grip: impact-resistant plastic (cadmium-free).

Order no.	SW	L1	B	D	L	Weight [g]
44115	8	125	100	14	151	122
44123	10	125	100	17	155	150

On request:

Other lengths and executions on request. On request with advertising or company imprint.

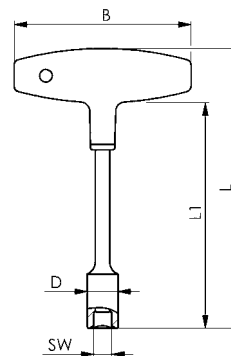

DIN 904

Square socket spanner

Special steel, body and tommy bar hardened and **blued**. Tommy bar pressed in.



Order no.	SW	D1	D2	L1	L2	L4	Weight [g]
41665	4	12,0	6,0	60	160	11	85
41673	5	12,0	6,0	60	160	11	85
41681	6	12,0	6,0	80	160	12	100
41699	7	14,6	6,0	80	160	15	130
41707	8	16,0	9,0	80	180	15	180
41715	9	18,0	9,0	100	180	18	245
41723	10	20,0	11,0	100	200	18	340
41731	12	24,0	12,0	100	250	21	520
41749	13	24,0	12,0	100	250	22	520
41756	14	28,0	14,6	120	320	24	875
41764	17	34,0	16,0	160	400	28	1625
41772	19	36,0	16,0	200	400	30	2035
41780	22	42,0	18,0	200	500	34	2900
41798	24*	45,0	20,0	250	630	36	4270

* Contrary to DIN standard, shaft is not bored.

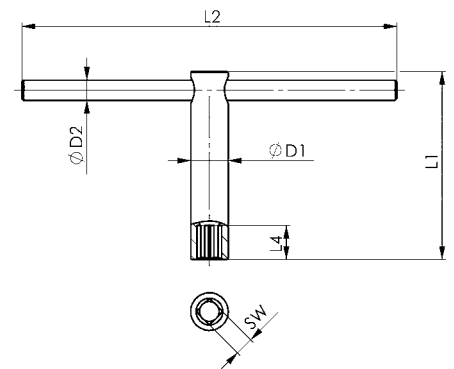

DIN 904L

Square socket spanner

long version. Special steel, body and tommy bar hardened and **blued**. Tommy bar pressed in.



Order no.	SW	D1	D2	L1	L2	L4	Weight [g]
41848	5	12	6,0	120	160	11	100
41855	6	12	6,0	160	160	12	110
41863	8	16	9,0	160	180	15	210
41871	9	18	9,0	200	200	18	390
41889	10	20	11,0	200	200	18	390
41897	12	24	12,0	200	250	21	600
41905	13	24	12,0	200	250	22	600
41913	14	28	14,6	200	320	24	795
41921	17*	34	16,0	250	400	28	1500
41939	19*	36	16,0	320	400	30	1700

* Contrary to DIN standard, shaft is not bored.

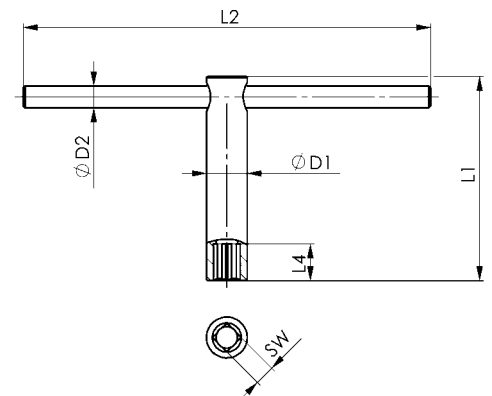

DIN 248

Square ring spanner

Special steel, hardened and **blued**.



Order no.	SW	D	L	Weight [g]
40022	8	17	160	85
40030	10	21	195	165
40048	12	24	235	275
40105	13	26	250	300
40055	14	27	270	420
40063	17	31	315	530
40071	19	35	345	715
40089	22	39	385	900
40097	24	43	415	975

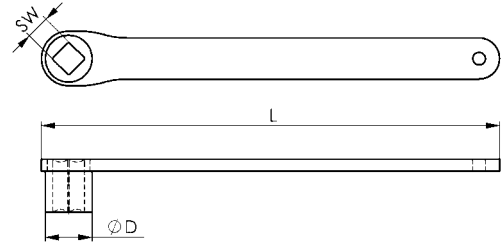

No. 916Q

Hexagon socket spanner with T-grip

Socket: CHROME-VANADIUM, hardened and **matt chrom-plated**.
Grip: impact-resistant plastic (cadmium-free).



Order no.	SW	L1	B	D	L	Weight [g]
45161	5,5	125	100	8	155	80
44248	6	125	100	9	155	90
44255	7	125	100	11	155	90
44263	8	125	100	12	155	95
45179	9	125	100	13	155	115
44271	10	125	100	14	155	120
44206	10	230	100	14	260	160
44297	13	125	100	18	155	140
44222	13	230	100	18	260	180
45237	16	125	100	22	155	155
45245	17	125	100	24	155	160

On request:

On request with advertising or company imprint.

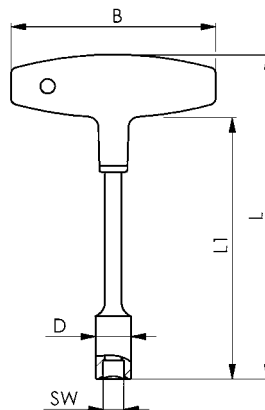

DIN 894

Open-ended spanner, single-ended

Special steel forging, jaws machined, angle of jaws 15°, hardened and **phosphated**

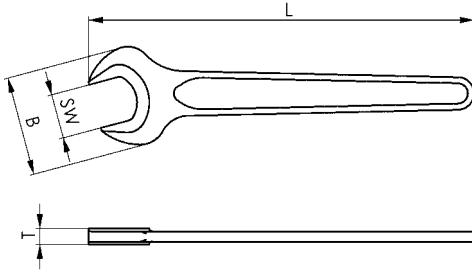

Order no.	SW	Thread metric	B	L	T	Weight [g]
53579	8	5	19	94	4	13
53595	10	6	22	105	5	20
53611	12	-	26	125	5	28
53629	13	8	29	125	5	35
53645	17	10*	36	155	6	65
53520	18	12	39	155	7	70
53652	19	12*	40	170	7	83
53660	22	14*	46	195	8	105
53678	24	16	50	215	9	150
53686	27	18	56	240	10	200
53694	30	20	62	265	11	265
53702	32	22*	67	275	12	295
53710	36	24	74	300	13	425

* Size to old DIN standard.

No. 714

Open-ended spanners, double-ended, thin version

CHROME-VANADIUM, hardened and **nickel-plated**. Jaws machined to DIN 475.



Order no.	SW	L	T	Weight [g]
51326	3x 3,5	120	1,5	8
51342	4x 4,5	120	1,5	8
51367	5x 5,5	120	1,5	8
51383	6x 6,5	120	1,5	8
51391	7x 8,0	125	2,0	18
51409	9x10,0	125	2,0	21

On request:

Other sizes on request.

No. 714T-6D

Open-ended spanners, double-ended, thin version

in plastic tool roll, 6-piece set.



Order no.	Contents	Weight [g]
51524	3x3.5, 4x4.5, 5x5.5, 6x6.5, 7x8, 9x10	90

The table shows the across-flat (A/F) sizes of metric Withworth and BSP threads:

A/F	3	3,2	3,5	4	4,5	5	5,5	6	6,5	7	8	9	10
Metric thread size [mm] (ISO 272)	1,2 1,4	1,6	1,8	2,0	2,3	2,5	3,0	3,5	-	4,0	5,0	-	6,0
Woodscrews [mm] (DIN 571)	-	-	-	-	-	-	-	-	-	4,0	5,0	-	6,0
Sheetscrews [mm] (ISO 1479, DIN 6928)	-	2,2	-	2,9	-	-	3,5 3,9	-	3,5 3,9	4,2	4,8 5,5	-	6,3

Specifications subject to change.

THE MANUFACTURE OF SPECIAL HANDTOOLS TO CUSTOMERS' INDIVIDUAL REQUIREMENTS IS AN AMF SPECIALITY.

Such handtools can be either specially designed and produced, or cost-effectively modified from an item in the comprehensive AMF product range to meet your needs. To start with, drawings or sketches and the required quantities are all we need.

Specials, just as you need them, in widely differing forms and versions. Top quality for a long working life. From specialists for specialists!

Please formulate your enquiry as accurately as possible. We assure you that we will reply by return. The details we need are given in the list below:



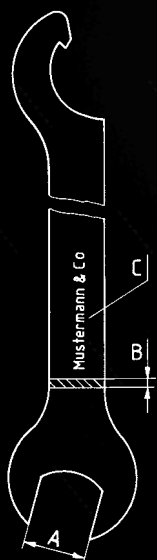

- 1) DIN designation or drawing no.
- 2) Quantity.
- 3) Across-flats size and angle of jaws (A).
- 4) Material:
special steel, CrV steel or stainless steel.
- 5) Execution of edges:
punch-rounded, broken by buffing, edge ground etc.
- 6) Thickness of spanner (B).
- 7) Strength requirements:
hardened or unhardened.
- 8) Surface finish:
blued, nickel-plated or zinc-plated.
- 9) Marking (C):
company name, size, description.
- 10) For hook wrenches:
hook form, pin diameter.
- 11) For pin spanners:
pin spacing and diameter.
- 12) Delivery date.



No. 902
Open-ended spanner, single-ended

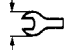

stamped from steel sheet. Material, thickness, strength properties and other details to your specification.



			 *	Minimum order quantity
3/3,2/3,5/4	65	11	1 - 2	100
4,5/5	75	15	1 - 2	
5,5/6	75	15	1 - 3	
7/8	92	18	2 - 4	
9/10	100	21	2 - 4	
11/12	115	24	2,5- 5	
13/14	135	30	3 - 6	
15/16/17	145	35	3 - 6	50
18/19/20	175	42	3 - 6	
21/22/23	195	48	4 - 8	
24/25/26	215	54	4 - 8	
27/28	235	58	4 - 8	
30/32/34	260	66	4 - 10	25
36/41	310	84	5 - 10	
46/50	385	102	5 - 10	10
55	375	120	5 - 10	10
60	385	120	5 - 10	10
65	385	120		
70	390	140		
75	410	150	5 - 10	5
80	420	158		
85	445	172		
90	450	180	5 - 10	5
95	465	190		
100	470	200		
105	500	200	6 - 12	2
110	500	210		
115	510	225		
120	530	235	6 - 12	2
130	560	252		
135	585	265		
145	595	280	7 - 15	2
150	620	280		
155	620	300		
165	680	330	7 - 15	2
175	690	340		
180	690	355		
185	700	360	7 - 15	2
190	730	360		
200	740	380		

* Optimum thickness range.

No. 685
Open-ended spanner, single-ended, short form

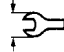
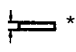
			 *	Minimum order quantity
8/9	85	22	2 - 4	100
10/11/12	93	26	2 - 4	
13/14/15	98	30	2,5- 5	
16/17	100	37	2,5- 5	
18/19	100	40	2,5- 5	50
20/21/22/23/24	120	47	3 - 6	
25/26/27/28	130/180	55	3 - 6	
30/32	140	66	4 - 8	25
36	160	74	4 - 8	
41	170	84	5 - 10	10
46	185	96	5 - 10	
50	185	96	5 - 10	
55	195	106	5 - 10	
60	208	120	5 - 10	
65	218	125	6 - 12	
70	245	135		
75	255	142		
80	275	150		
85	275	170		
90	280	180		
95	305	185		
100	310	200		
105	310	205		
110	330	216		7 - 15
115	355	235		
120	360	235		
130	370	250	10 - 20	
135	385	250		
145	420	280		
150	500	315		

* Optimum thickness range.

No. 658 Open-ended spanner, double-ended

(previously DIN 658)

Across-flat pairings to your specification

					Minimum order quantity
3,2 - 4,0 4,0 - 5,0 5,0 - 5,5	60 72 84	9,0 9,5 12,0	10,0 10,5 13,0	1 - 2,0 1 - 2,0 1 - 2,5	100
5,5 - 8,0 8,0 - 9,0 8,0 - 11,0	100 110 125	15,5 18,0 22,0	18,0 20,0 24,0	1,5 - 3 2,0 - 4 2,5 - 5	100
11 - 14 13 - 17 17 - 19	144 162 175	25,5 30,0 35,0	29,0 35,0 40,0	3,0 - 6	100 100 50
19 - 22 22 - 24 24 - 27	220 225 250	42,0 46,0 53,0	46,0 50,0 60,0	4 - 8 4 - 8 5 - 10	50
27 - 32 32 - 36	285 305	63,0 66,0	66,0 74,0	5 - 10	50

* Optimum thickness range

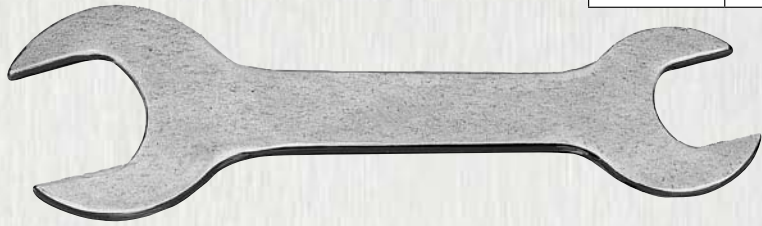

No. 710 Open-ended spanner, double-ended

(German Post standard)

					Minimum order quantity
3,2 - 4,0 4,0 - 5,0 5,0 - 5,5	90	10 11 13	11 11 13	1,5 2,0 2,5	100
5,5 - 8,0 8,0 - 9,0 8,0 - 11,0	90 125 -	14 18 -	14 18 -	3,0 4,0 -	100
9,0 - 9,0 10,0 - 10,0 10,5 - 11,0	125	20 22 24	20 22 24	5,0	100
11 - 14 13 - 17 17 - 19	125	26 30 35	26 30 35	5,0	100 100 50



DIN 3115 Spanner for nuts with slotted face, version B

Nuts size	a	b	f	h	L
M 5	1,8	9,8	5,5	6	50
M 6	2,3	10,8	6,5	7,5	65
M 8	2,8	13,8	9,0	9	80
M 10	3,3	17,8	11	11	90
M 12	3,8	21,8	13	12	100
M 14	3,8	23,8	15	12	100
M 16	3,8	26,8	17	14	125
M 18	3,8	29,8	19	14	140
M 20	4,8	31,8	21	15	160

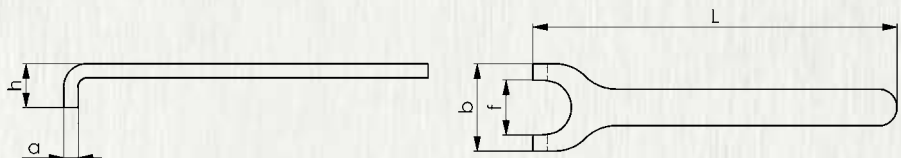

... BY ARTICLE NO.

Article no.	page	Article no.	page	Article no.	page	Article no.	page	Article no.	page	Article no.	page
DIN 14822	47	DIN 3116C	50	No. 771C	46	No. 906M	9	No. 910	9	No. 911LG-WM9	25
No. 14822	47	DIN 317	53	No. 771Md	46	No. 906Q	12	No. 911BM10D	18	No. 911L-HM9C	20
DIN 1810A	40	No. 318	53	No. 775C	44	No. 906QE	10	No. 911BM7D	18	No. 911L-HM9D	21
DIN 1810AD	40	DIN 6368	54	No. 775D	44	No. 906QE-WM7	11	No. 911BZ7	32	No. 911L-HZ 9D	31
DIN 1810B	41	No. 658	62	No. 775NI	44	No. 906QGE	26	No. 911G-BM10	24	No. 911L-TM7	19
DIN 1810BD	41	No. 685	61	No. 775SC	42	No. 906Q-WM7	13	No. 911G-C	23	No. 911L-WM9	17
DIN 22417A	55	DIN 6911D	22	No. 775SNI	42	No. 906QZ	30	No. 911G-TM7	24	No. 911L-WM9M	16
No. 248	58	No. 6911 BM7	22	No. 776C	45	No. 906S	12	No. 911-HM9C	20	No. 911TM	19
No. 250	51	No. 710	62	No. 776D	45	No. 906-WM7M	13	No. 911-HMD	21	No. 911TZ	32
No. 250K	54	No. 714	59	No. 776Md	46	No. 906-WM9	13	No. 911HZ 9D	31	No. 911-WM9	17
No. 250Md	52	No. 714T-6D	59	No. 776SC	43	No. 907LE	35	No. 911L-BM8D	19	No. 911-WM9M	16
ISO 2936C	14	DIN 7417	56	DIN 894	59	No. 907Q	36	No. 911LG-BM8C	28	No. 911-WZ9	30
ISO 2936D	15	No. 756-760	48	No. 902	61	No. 907Q-WT7	36	No. 911LG-BM8D	28	No. 914Q	56
No. 2936DZ	29	No. 758	48	No. 902Md	52	No. 907S	35	No. 911LG-C	25	No. 916Q	58
ISO 2936LC	14	No. 758S	48	DIN 904	57	No. 907SH	34	No. 911LG-D	25	No. 918-HT8C	37
ISO 2936LD	15	No. 758CC	48	DIN 904L	57	No. 908	33	No. 911LG-HM7D	27	No. 937SH	34
No. 2936LDZ	29	No. 759CC	48	DIN 905	55	No. 908L-HT13C	37	No. 911LG-HM9D	27	No. 960	54
DIN 3115	62	No. 764AZ	49	No. 906	12	No. 908-TT9	33	No. 911LG-HMC	27	No. 966QGE	26
DIN 3116	50	No. 764AZ4	49	No. 906E	11	No. 909EG7	24	No. 911LG-HZ13D	31		
DIN 3116A	50	No. 764C	49	No. 906GE	26	No. 909ET8	37	No. 911LG-TM9	28		

... BY ORDER NO.

Order no.	page	Order no.	page	Order no.	page	Order no.	page	Order no.	page	Order no.	page
40022	58	41111	49	42093	55	42663	15	43430	29	44057	30
40030	58	41129	49	42101	55	42671	15	43448	29	44065	17
40048	58	41137	49	42119	55	42689	15	43455	29	44099	17
40055	58	41145	49	42168	12	42697	15	43463	29	44115	56
40063	58	41152	49	42184	12	42705	15	43471	29	44123	56
40071	58	41160	49	42192	12	42713	15	43497	29	44156	31
40089	58	41277	49	42200	12	42721	15	43505	29	44164	31
40097	58	41285	49	42218	12	42739	15	43513	29	44180	31
40105	58	41665	57	42234	12	42747	15	43521	29	44206	58
40147	53	41673	57	42242	12	42754	15	43539	29	44222	58
40154	53	41681	57	42259	12	42762	15	43547	29	44248	58
40162	53	41699	57	42283	13	42770	15	43554	29	44255	58
40170	53	41707	57	42291	13	42788	15	43562	29	44263	58
40188	53	41715	57	42341	25	42796	15	43570	29	44271	58
40220	53	41723	57	42358	14	42895	15	43588	29	44297	58
40238	53	41731	57	42366	14	42903	15	43596	15	44354	55
40477	48	41749	57	42374	14	42911	15	43604	29	44362	55
40485	48	41756	57	42382	14	42937	15	43612	29	44370	55
40493	48	41764	57	42390	14	42945	15	43638	29	44388	55
40618	48	41772	57	42408	14	42952	15	43646	29	44396	55
40626	48	41780	57	42416	14	42960	15	43703	14	44404	55
40634	48	41798	57	42424	14	42978	15	43711	14	44412	55
40758	48	41848	57	42432	14	42986	15	43729	14	44453	50
40766	48	41855	57	42440	14	42994	15	43737	14	44461	50
40774	48	41863	57	42457	14	43000	15	43745	14	44479	50
40899	48	41871	57	42465	14	43018	15	43752	14	44487	50
40907	48	41889	57	42473	14	43067	14	43760	14	44495	50
40915	48	41897	57	42481	14	43273	29	43778	14	44503	50
40931	11	41905	57	42499	14	43281	29	43786	14	44511	50
40949	11	41913	57	42507	14	43299	15	43794	14	44529	50
40956	11	41921	57	42515	14	43307	29	43802	14	44537	50
40998	49	41939	57	42523	14	43315	29	43810	14	44545	50
41004	49	41988	55	42531	14	43323	29	43836	33	44552	50
41012	49	41996	55	42549	14	43331	29	43851	19	44560	50
41020	49	42002	55	42556	14	43349	29	43869	19	44628	50
41038	49	42010	55	42564	14	43356	29	43877	19	44636	50
41046	49	42028	55	42572	14	43364	29	43885	28	44644	50
41053	49	42036	55	42580	14	43372	29	43893	32	44651	50
41061	49	42044	55	42606	13	43380	29	43901	32	44669	50
41079	49	42051	55	42614	15	43398	29	43919	32	44685	50
41087	49	42069	55	42630	15	43406	29	43927	19	44727	54
41095	49	42077	55	42648	15	43414	29	44032	16	44735	54
41103	49	42085	55	42655	15	43422	29	44040	16	44743	54

... BY ORDER NO. (CONTINUED)

Order no.	page	Order no.	page	Order no.	page	Order no.	page	Order no.	page	Order no.	page
44750	54	45922	36	47274	25	49254	10	53058	45	54981	41
44768	54	45930	36	47282	25	49262	10	53066	45	54999	41
44776	54	45948	36	47290	25	49270	10	53074	45	55004	41
44784	54	45955	36	47407	35	49288	10	53082	45	55012	41
44792	54	45963	36	47415	35	49577	11	53090	45	55020	41
44800	9	45989	36	47423	35	50427	48	53108	45	55038	41
44826	18	46003	19	47431	35	50914	48	53116	45	55046	41
44842	32	46011	28	47449	35	50922	48	53124	45	55053	41
44867	22	46029	36	47456	35	50930	48	53132	45	55061	41
44875	9	46037	18	47464	34	50948	48	53140	45	55079	41
44883	30	46052	24	47472	34	50997	50	53157	45	55103	40
44891	30	46060	25	47480	34	51201	46	53165	45	55111	40
44909	30	46078	28	47498	34	51219	46	53173	45	55129	40
44917	30	46086	25	47506	34	51227	46	53181	45	55137	40
44925	30	46102	24	47514	34	51326	59	53199	45	55152	40
44933	30	46136	21	47522	34	51342	59	53520	59	55160	40
44958	12	46185	34	47530	34	51367	59	53579	59	55178	40
44966	12	46458	23	47548	12	51383	59	53595	59	55186	40
44974	12	46466	23	47555	12	51391	59	53611	59	55202	40
44982	12	46474	23	47563	12	51409	59	53629	59	55210	40
44990	12	46490	23	47571	12	51516	46	53645	59	55236	40
45005	12	46516	23	47613	26	51524	59	53652	59	55251	40
45013	12	46524	27	47621	26	51532	46	53660	59	55269	40
45021	12	46532	23	47639	26	51557	46	53678	59	55277	40
45039	12	46540	33	47670	26	51649	44	53686	59	55285	40
45047	12	46557	23	47779	49	51656	44	53694	59	55400	41
45054	12	46565	33	47787	49	51664	44	53702	59	55418	41
45062	12	46573	23	47795	49	51672	44	53710	59	55426	41
45070	12	46581	33	47803	49	51680	44	54387	40	55434	41
45096	12	46599	23	47811	49	51730	44	54403	40	55442	41
45112	12	46607	33	47829	49	51748	44	54429	40	55459	41
45120	30	46615	33	47837	49	51755	44	54445	40	55467	41
45161	58	46623	33	47845	49	51763	44	54585	40	55475	41
45179	58	46631	33	47852	49	51771	44	54593	40	55483	41
45237	58	46649	33	47860	49	51821	43	54601	40	55491	41
45245	58	46656	33	47878	49	51839	43	54619	40	55509	41
45252	30	46664	33	47886	49	51847	43	54627	40	55517	41
45260	30	46672	33	47894	54	51854	43	54635	40	55525	41
45294	30	46680	33	47902	54	51862	43	54643	40	55533	41
45310	30	46698	33	47910	54	51870	43	54650	40	55541	41
45336	47	46706	33	47928	54	51888	43	54668	40	55558	41
45344	47	46722	36	47936	54	51896	43	54676	40	56002	56
45369	37	46730	35	47944	54	51904	43	54684	40	56010	56
45377	22	46748	35	48900	37	51912	43	54692	40	56028	56
45385	22	46755	35	49007	10	52183	44	54700	40	56044	56
45393	22	46763	35	49015	10	52191	44	54718	40	56697	42
45401	22	46771	35	49023	10	52209	44	54726	40	56705	42
45419	22	46789	21	49031	10	52217	44	54734	40	56713	42
45427	22	46797	21	49049	10	52225	44	54742	40	56721	42
45435	22	46805	27	49056	10	52233	51	54759	40	56739	42
45443	22	46813	27	49064	10	52241	51	54767	40	56796	42
45450	22	46847	34	49072	10	52258	51	54775	40	56804	42
45641	24	46854	34	49080	10	52266	51	54783	40	56812	42
45658	37	46862	34	49098	10	52274	51	54791	40	56820	42
45666	9	46870	34	49106	10	52290	51	54809	40	56838	42
45757	26	46888	34	49114	10	52308	52	54817	40	89409	27
45765	26	46896	34	49122	10	52316	52	54825	40	89425	20
45773	26	46987	34	49130	10	52324	52	54841	40	89433	20
45781	26	47118	26	49148	10	52340	52	54874	41		
45823	25	47126	26	49155	10	52407	54	54882	41		
45831	25	47134	26	49163	10	52415	54	54890	41		
45849	25	47142	26	49171	10	52423	54	54908	41		
45856	25	47209	25	49189	10	52431	54	54916	41		
45864	25	47217	25	49197	10	52449	54	54924	41		
45872	25	47225	25	49205	10	52506	52	54932	41		
45880	25	47233	25	49213	10	52514	52	54940	41		
45898	25	47241	25	49221	10	52522	52	54957	41		
45906	36	47258	25	49239	10	52753	46	54965	41		
45914	36	47266	25	49247	10	52761	46	54973	41		

... IN ALPHABETICAL ORDER

A	page	L	page
Adjustable face spanner set	48	Loose pin with nut	49
Adjustable hook wrench with nose	46		
Adjustable hook wrench with nose and torque socket	46	O	
Adjustable pin wrench for nuts with 2 holes	48	Open-ended spanner	59, 61, 62
		Open-ended spanner with torque-wrench socket	52
B		Open-ended spanner, single-ended	59
Ball-ended hexagon key (metric)	23	Open-ended spanners, double-ended, thin version	59
Ball-ended hexagon key (metric) with T-grip	26		
Ball-ended hexagon key (metric) with screwdriver grip	26	P	
Ball-ended hexagon key (metric), long version	25	Pin with nut, loose	49
Ball-ended SCHRAUB-boy	24	Pin wrench for nuts with 2 holes, adjustable	48
Ball-ended TORX hexagon key	37	Pin wrench for nuts with 2 holes, hinged	49
Biketool	9	Pin wrenches	48-50
C		S	
Collet chuck key	51	SCHRAUB-boy (metric)	9
Collet chuck key (Mini)	54	SCHRAUB-boy, ball-ended	24
Coupling wrench for fire hydrant couplings	47	Screwdriver for square drive bolts	55
		Socket spanner	55-58
D		Socket wrench for coolant tubes HSK-A	54
Double hexagon key (metric) with T-grip	26	Special-Coupling wrench for fire hydrant couplings	47
Drill drift	53	Square ring spanner	58
		Square socket key	56
F		Square socket spanner	57
Face spanner set, adjustable	48	Square socket spanner with T-grip	56
H		T	
Hexagon key (metric) with pilot	22	TORX angled key	33
Hexagon key (metric) with screwdriver grip	11	TORX hexagon key, ball-ended	37
Hexagon key (metric) with T-grip	10	TORX key holder	37
Hexagon keys (inch)	29	TORX key wallet	33
Hexagon keys (inch) with T-grip	30	TORX key with screwdriver grip	35
Hexagon keys (inch), long version	29	TORX key with small grip	35
Hexagon keys (metric)	9-21	TORX key with T-grip	36
Hexagon keys (metric) with screwdriver handle	12	TORX keys with flag-type grip	34
Hexagon keys (metric) with small grip	12	TORX SCHRAUB-boy	37
Hexagon keys (metric) with T-grip	12	TORX workshop stand	36
Hexagon keys (metric), long version	14, 15	TORX-PLUS keys with flag-type grip	34
Hexagon keys with pilot	22	Triangular socket spanner	55
Hexagon socket spanner with T-grip	58		
Hinged hook wrench with nose, assembly version	42	W	
Hinged hook wrench with nose, industrial version	44	Workshop stand (inch)	30
Hinged hook wrench with pin and torque-wrench socket	46	Workshop stand (metric)	11, 13, 17
Hinged hook wrench with pin, assembly version	43	Workshop stand (metric), ball-ended	25
Hinged hook wrench with pin, industrial version	45	Workshop stand (metric), metal	13, 16
Hinged pin wrench for nuts with 2 holes	49	Wrench for 2 hole nuts	50
Hock wrench with pin	41	Wrench for milling arbor screws	54
Hook wrench with nose	40	Wrenches for machine tools	51-54
Hook wrench with nose and torque socket, adjustable	46		
Hook wrench with nose, adjustable	46		
Hook wrench with nose, hinged	42, 44		
Hook wrench with pin, hinged	43, 45		
K			
Key box	24, 28		
Key box (inch)	32		
Key box (metric)	18, 19, 22		
Key for collet chuck with torque-wrench socket	52		
Key holder	27		
Key holder (Combiclip)	27		
Key holder (inch)	31		
Key holder (metric)	20, 21		
Key holder, ball-ended (inch)	31		
Key wallet	24, 28		
Key wallet (metric)	19		
Key wallets (inch)	32		

These conditions of sale apply to business conducted with companies, legal entities in the public sector, and legal entities with special budget in the public sector. Our deliveries and services are carried out exclusively on the basis of the conditions stated below. Deviating purchasing conditions of the buyer will not become part of the contract, not even through acceptance of the order, unless we have expressly accepted them.

1. Offer and entering into a contract

The basis of our delivery contracts is the latest edition of our catalogue. Orders are not considered as accepted until they have been confirmed by us in writing. When goods are supplied from stock and, for organisational reasons, you receive no separate confirmation, the invoice has the additional function of confirming the order. Details of dimensions and weights, and illustrations, drawings and data are not binding and may be changed by us at any time. Deviations cannot be excluded.

2. Prices

Prices are quoted in EUR ex-works excluding turnover tax, packing, freight, carriage, and insurance. Unless otherwise agreed, our list prices on the day of delivery apply. In order to cover our costs, orders under EUR 50.- net value are subject to a small order surcharge of EUR 10.-.

3. Delivery

Delivery delays are quoted to the best of our knowledge but without guarantee. Agreed delivery delays begin on the day we accept the order and refer to the completion of the goods in our works.

4. Transfer of risk

Risks are transferred to you when the goods are passed to a specific person, company, or organisation that is charged with the execution of carriage of the goods. This applies also to partial deliveries and when we have accepted the costs of carriage, delivery or erection. The risks are also transferred to you when you have defaulted on acceptance.

5. Dispatch

Goods are supplied ex-works. Dispatch is at your cost and risk. Scheduled, FOB, and CIF deliveries are also at your risk. In the absence of specific instructions concerning dispatch, we will arrange same as we think fit, but without accepting any responsibility for choosing the cheapest or most suitable method of dispatch. We make a handling charge of EUR 5.- if goods are sent at your request to a third party. You accept that your order can be supplied in partial deliveries insofar as this is reasonable.

6. Reservation of proprietary rights

Goods delivered remain our property until payment of all claims has been received in full or until redemption of cheques given in payment. The cancellation of individual positions in an open invoice and the drawing of a balance and its acceptance do not affect proprietary rights. You have the right to dispose of the goods as a normal commercial transaction, but you are forbidden to pawn, mortgage, or transfer ownership of them in settlement of a debt or debts. You surrender to us herewith your right to payment for goods for which we reserve our proprietary rights. You have the right to collect these payments as long as you meet your obligations to us. If we request it, you are obliged to name the third party and we have the right to publish this information and the transfer of rights.

7. Cancellation rights due to late payment or insolvency

If you do not pay for the goods by the time payment is due, and if you have not paid after expiry of a reasonable time limit set by us, we have the right to withdraw from the contract and demand the return of goods already supplied. Rights under § 323 BGB (BGB = German civil law code) remain otherwise unaffected. Application for the opening of insolvency proceedings gives us the right to withdraw from the contract and demand the immediate return of goods supplied before the bankruptcy court orders protective measures.

8. Packaging

Packages comply with the German packaging regulations (WO). Disposable packaging is charged at cost. The packaging is not returnable.

9. Tooling costs

In the absence of any agreement to the contrary, tooling made for the execution of an order remains our property in all cases. This applies even if we have made a charge for a proportion of the tooling costs.

10. Payment

Our invoices are payable net within 30 days of the date of the invoice, or with 2% discount if paid within 10 days. Invoices below EUR 50.- are payable immediately without discount. Our credit notes and your charges on us reduce the amount subject to discount. Late payment entitles us to interest at the rate the bank charges us for a current account overdraft but at least 8 percent above the current base rate of the European Central Bank. If payment is overdue, we are entitled, after giving you notice in writing, to cease fulfilling our obligations under the contract until payment is received.

11. Offsetting exclusion

You can only offset payments with legally-established or unopposed counter claims.

12. Guarantee

If you come to an agreement with us on properties of the goods, we include this agreement in our technical specifications. If we have to supply to your drawings, specifications, samples, etc., you accept the risk associated with suitability for the intended purpose. The point in time at which risk is transferred is decisive for the contractual condition of the goods. The deterioration of parts subject to wear in the course of normal use does not constitute a defect. If the goods supplied are defective, we will – at our choice and within a reasonable time limit set by you – supply a replacement or repair the goods. If such repair or replacement is not satisfactory, you have the right to reduce the price or withdraw from the contract. Any further guarantee claims are excluded. Recognisable defects must be notified at the latest within 10 days of receipt and defects that are not recognisable must be notified as soon as they are discovered. The guarantee period is 24 months and starts with dispatch of the goods from our works.

13. Hindered or impossible performance

If we are prevented from meeting our obligation by some unforeseeable event (e.g. disruption of our plant, or delay in the delivery of important raw materials), which, in spite of taking all reasonable care appropriate to the circumstances of the case, we have been unable to avert, and it has become impossible to execute the delivery or service punctually, the delivery delay will be extended to an appropriate extent.

14. Liability

Except in the case of injury to life or limb, or damage to health caused by our breach of duty, we are only liable in the event of intent or culpable negligence on our part.

15. Customer specials

Orders for customer specials must be in writing and include binding details of execution, quantities etc. For technical reasons we reserve the right to supply 10% more or less than the quantity specified. If technical changes or cancellation are required, the costs incurred will be charged to the customer.

16. Deliveries of samples and return of goods

Samples will be charged. When goods have been sent for testing or as samples, we will credit you with the additional price against subsequent orders, as long as the net contract value is at least EUR 125.-. The return of goods is only possible with prior agreement. Customer specials may not be returned. For goods returned for reasons outside our responsibility (e.g. wrongly ordered), we charge 10% of the value of the goods but at least EUR 7.50, to cover administration costs.

17. Place of fulfilment, court of jurisdiction

The place of fulfilment for all obligations arising from this contract is D-70707 Fellbach. The court of jurisdiction for any legal dispute arising from this contract is D-71332 Waiblingen. (All disputes that arise from this contract or about its validity will be decided by a court of arbitration according to the Arbitration Rules of the German Committee for Arbitration Courts/Settlement and Arbitration Procedure of the International Chamber of Commerce. Such decisions will be final and normal legal procedures are excluded.) German law applies (BGB and HGB = civil and commercial codes). The application of UN purchasing law (CISG) is excluded.

18. Validity clause

If individual conditions should be found to be not legally valid, the remaining conditions continue to apply. The invalid conditions will be replaced by conditions which fulfil as closely as possible the commercial intent of the contract with reasonable consideration of the interests of both parties. With the publication of these Conditions for Sales, Deliveries and Payment, all previous versions become invalid. This does not apply to contracts agreed before publication.

...just copy
and mail or fax

REQUEST FOR CATALOGUES:

- | | |
|--|--|
| <input type="checkbox"/> Locks for doors and gates | <input type="checkbox"/> Clamping and fixture systems |
| <input type="checkbox"/> Hand tools | <input type="checkbox"/> Magnetic clamping technology |
| <input type="checkbox"/> Toggle clamps, manual and pneumatic | <input type="checkbox"/> Zero-Point Systems |
| <input type="checkbox"/> Mechanical clamping elements | <input type="checkbox"/> Clamping and fixture system for automated welding |
| <input type="checkbox"/> Hydraulic clamping systems | <input type="checkbox"/> Positioning system for laser marking |

Company/Address (please don't forget your phone no.)

ANDREAS MAIER
GmbH & Co. KG
Schloss- und
Werkzeugfabrik
Postfach 1760

70707 FELLBACH

responsible



HOW DO I ORDER?



AMF e-Business offers you new possibilities! Many of our customers have been ordering AMF products electronically for several years now. Currently, for more than 30% of our sales, orders are placed electronically and processed online. In the sidebar you will find the various ordering options with which you too can profit from the advantages that AMF e-Business offers.

E-COMMERCE AT AMF - THE AMF ONLINE SHOP

In our new AMF Online Shop, AMF offers you the best conditions for your Internet buying. Its basis today is a media-neutral database from which our Online Shop and related print media are generated fully automatically. In this way you always have immediate access to the latest products and revisions.

Using the direct online connection to the AMF inventory control system, you can check the availability and delivery of the goods you need, and check the current status of your order at any time.

If you are a registered customer, you can log in to access your specific, individual prices and order data.

1. Use the „Products“ menu item to go to our Online Shop.
2. Register without obligation; your access data will be sent to you automatically by e-mail.
3. Study our range of products and select those you need on the individual product pages, or use „Rapid registration“ to put them straight in the trolley.
4. Go to „Prices and availability“ to check when a product can be supplied.
5. When you order: send off your order, and you are 98% certain to receive your goods on the next working day (within Germany).
6. The entire system is supplemented and enhanced by integration of the CAD data for AMF products. These are available to our customers free of charge, in over 60 CAD formats, direct from the AMF Shop.

Go online with us – test our website and register so that you have all these advantages. We look forward to your visit ...

IN THE ONLINE SHOP:

Register at www.amf.de/products and order at the click of a mouse - simple and uncomplicated.

USING EDIFACT:

you can order direct from your inventory control system. If desired you can also receive the delivery note and invoice via EDIFACT.

IN E-MAIL FORMAT:

you send us the necessary data for your order. Please ask us how it must be formatted.

BY TELEPHONE:

just as before, all information is available from our service staff

+49 711 5766-176

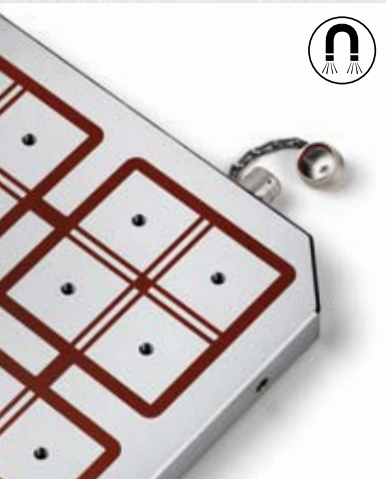

MAGNETIC CLAMPING TECHNOLOGY



HYDRAULIC CLAMPING SYSTEMS



„ZERO-POINT“ CLAMPING SYSTEM



CLAMPING AND FIXTURE SYSTEMS



TOGGLE CLAMPS, MANUAL AND PNEUMATIC



VACUUM CLAMPING TECHNOLOGY



STANDARD CLAMPING ELEMENTS

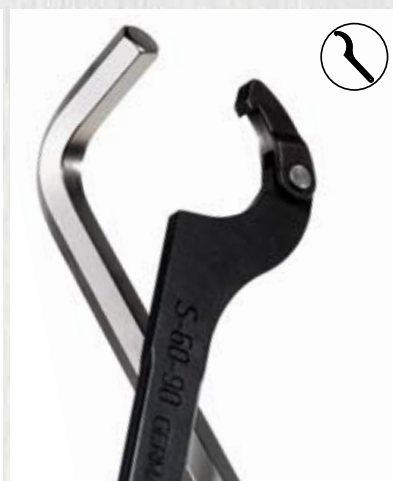

HAND TOOLS



CLAMPING. SCREWING. LOCKING.